

OREGON CORNER RESTORATION FORM

Section 25

Township 3N

Range 29E

County Umatilla

Date: 05/05/09

Corner Designation: 3N29T25

Corner common to section 25, T3NR29E, and section 30, T3NR30E.

- Condition Report Only
- Not Found
- Remonumented
- Unrecorded
- Surveyed In
- Referenced Out

Previous Renewals / Surveys, etc.

Originally Surveyed by David P. Thompson in 1859. He set a post in a mound of earth.

Monuments and Accessories Found: (Condition and Source)

Diagram

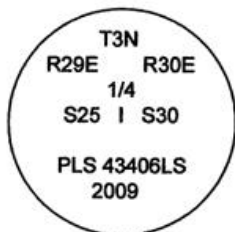

Sketch

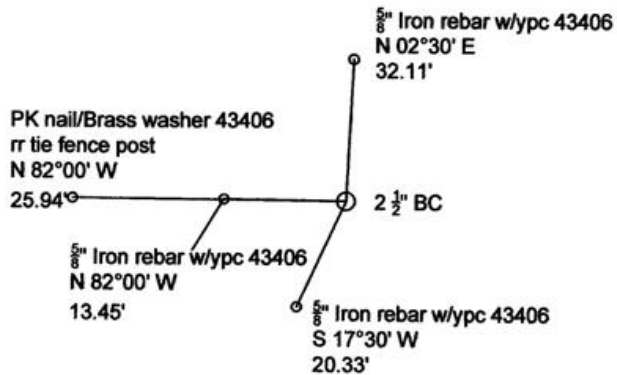

NAD 83/91
OREGON STATE PLANE NORTH
INTERNATIONAL FEET

N748682.45
E8554156.64

LAT - 45° 42' 43.1378" N
LON - 119° 07' 18.19577" W

Monument (s) Set (Procedures and Description)

Set A 1"x30" flared galvanized iron pipe with a 2 1/2" B.C. by best evidence at a 3-way fence intersection, north, south, west.

References Set:

- A 5/8" x 30" Iron rebar w/ypc #43406 lies N 02°30' E, 32.11'
- A 5/8" x 30" Iron rebar w/ypc #43406 lies S 17°30' W, 20.33'.
- A 5/8" x 30" Iron rebar w/ypc #43406 lies N 82°00' W, 13.45'.
- A PK nail/Brass washer #43406 lies N 82°00' W, 25.94'.

Location and Comments

The corner is 2.5 miles south of the intersection of Coppinger Lane and Highway 320.

Compass Declination
17° E

Surveyors Seal

REGISTERED
PROFESSIONAL
LAND SURVEYOR

Robert D. English
 OREGON
 JANUARY 11, 2005
 ROBERT DOUGLAS ENGLISH
 43406LS

RECEIVED BY:

Date: 5-09
 Rec'd By: JK
 No. 09-11-R

Firm / Agency

Survey One, LLC.
 P.O. Box 382
 Pendleton, OR 97801
 (541) 276-2055

RENEWAL DATE: 12/31/09