

**OREGON CORNER RESTORATION FORM**

Section 21,28 Township 3N  
County Umatilla Date: 8/11/10

Range 29E

Corner Designation: 3N29R11

1/4 corner common to sections 21 and 28 T3NR29E.

- \_\_\_\_\_ Condition Report Only
- \_\_\_\_\_ Not Found
- \_\_\_\_\_ Remonumented
- \_\_\_\_\_ Unrecorded
- \_\_\_\_\_ Surveyed In
- \_\_\_\_\_ X \_\_\_\_\_ Referenced Out

**Previous Renewals / Surveys, etc.**

Originally Surveyed by Gates in 1859. He set a post in a mound of earth. Corner reset by Don Staebler in 1974 from found evidence of the corner. See Survey I-158-B.

**Monuments and Accessories Found: (Condition and Source)**

- A 2 1/2" Brass cap, approx. 12" out of ground at Staebler's called position.
- A 5/8" Iron rebar w/rpc #951 lies S 10°15' E, 216.08'.
- A 2 1/2" Brass cap lies S 28° E, 84.38'. Set by Edwards using double proportionate method.

**Diagram**

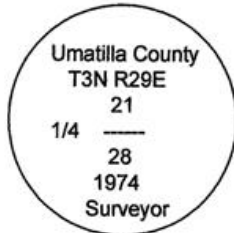

**Sketch**

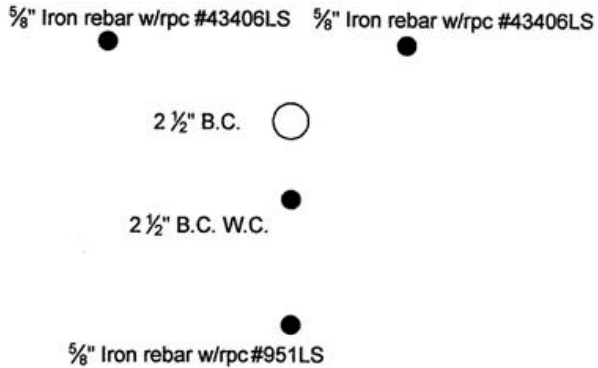

NAD 83/91  
OREGON STATE PLANE NORTH  
INTERNATIONAL FEET

N750953.12  
E8535545.68

LAT - 45° 43' 08.60495" N  
LON - 119° 11' 39.92997" W

**Monument (s) Set (Procedures and Description)**

None.

**References Set:**

- A 5/8" x 30" Iron rebar w/rpc #43406LS lies N 56°20' W, 17.24'.
- A 5/8" x 30" Iron rebar w/rpc #43406LS lies N 28°30' E, 19.36'.

**Location and Comments**

This corner falls on a Wly slope at the W edge of Piercy's Vineyard. Inside the vineyard fence.

**Compass Declination**  
17° E

**Surveyors Seal**

RECEIVED BY:

Date: 1-11  
Rec'd By: KK  
No. 11-17-R

**Firm / Agency**

Survey One, LLC.  
P.O. Box 382  
Pendleton, OR 97801  
(541) 276-2055

REGISTERED  
PROFESSIONAL  
LAND SURVEYOR

*Robert D. English*  
OREGON  
JANUARY 11, 2005  
ROBERT DOUGLAS ENGLISH  
43406LS

RENEWAL DATE: 12/31/11