

**OREGON CORNER RESTORATION FORM**

Section 4  
County Umatilla

Township 3N  
Date: 08/31/09

Range 29E

Corner Designation: 3N29E11

1/4 Corner common to sections 4 and 9, T3NR29E.

- Condition Report Only
- Not Found
- Remonumented
- Unrecorded
- Surveyed In
- Referenced Out

**Previous Renewals / Surveys, etc.**

Originally Surveyed by N.H. Gates in 1859. He set a post in a mound of earth w/charcoal.  
Haddock set a 2 1/4" Brass cap on a 1 1/8" x 24" galvanized iron pipe 6" below the surface.

**Monuments and Accessories Found: (Condition and Source)**

- Found A 2 1/4" B.C.
- Found a 5/8" Iron rebar w/ypc #852 lies N 52°30' W, 24.20'
- Found a 5/8" Iron rebar w/ypc #852 lies S 73°00' W, 20.19'
- Found a 5/8" Iron rebar w/ypc #852 lies N 63°00' E, 20.33'
- Found a 5/8" Iron pin SHRW for I-84, station 286+28, 165.00 left, lies S 21°00' E, 250.95'

**Diagram**

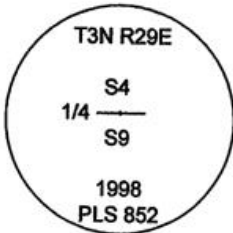

**Sketch**

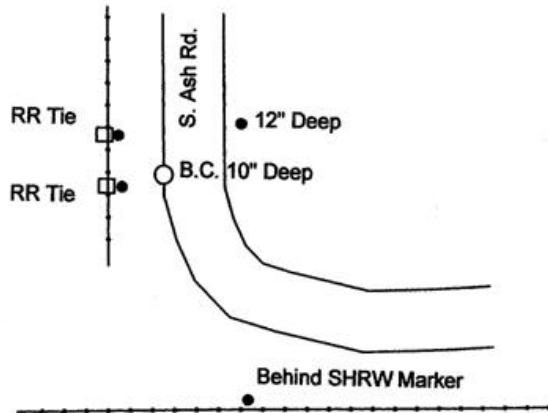

NAD 83/91  
OREGON STATE PLANE NORTH  
INTERNATIONAL FEET

N766788.89  
E8535340.76

LAT - 45° 45' 44.96303" N  
LON - 119° 11' 39.210580" W

**Monument (s) Set (Procedures and Description)**  
None.

**References Set:**  
None.

**Location and Comments**  
The corner is .5 miles south of the intersection of Irwin Rd. and S. Ash Rd, on S. Ash Rd.

**Compass Declination**  
17° E

**Surveyors Seal**

REGISTERED  
PROFESSIONAL  
LAND SURVEYOR

*Robert D. English*  
OREGON  
JANUARY 11, 2005  
ROBERT DOUGLAS ENGLISH  
43406LS

**RECEIVED BY:**

Date: 10-09  
Rec'd By: KK  
No. 09-146-R

**Firm / Agency**

Survey One, LLC.  
P.O. Box 382  
Pendleton, OR 97801  
(541) 276-2055

RENEWAL DATE: 12/31/09