

OREGON CORNER RESTORATION FORM

Section 5 Township 31N Range 29E
 County Umatilla Date 07-08-02
 Corner Designation 3N28R3

Condition Report Only
 Not Found
 Re-monumented
 Unrecorded
 Surveyed In
 Referenced Out

Previous Renewals / Surveys, etc.

Oregon Corner Restoration Form by David Haddock dated 5-21-98.

Set a punched railroad spike in place of a PK nail set in survey 91-61-B. Also found a brass capped witness corner set by survey S-158-C.

Monument and Accessories Found: (condition and source)

Found the record monument above.

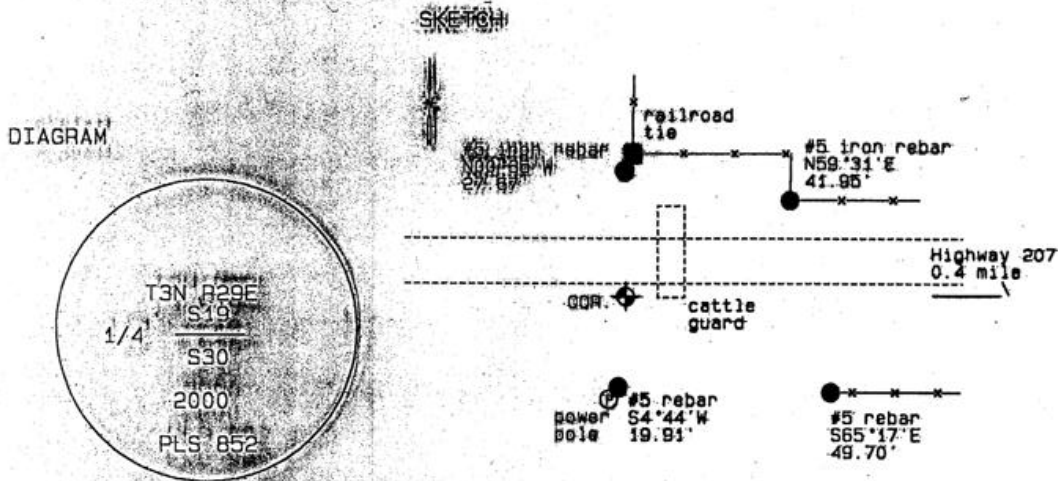

MONUMENT (S) AND ACCESSORIES SET (Procedures and Description)

None.

REFERENCES SET:

MOBE GPS tie to TRI Station
 Stanfield East Base
 Latitude: 45°43'08.65172"N
 Longitude: 119°21'45.65666"W
 NAD 83 (1991)

Oregon State Plane Coord. - North Zone
 Northing: 750338.34
 Easting: 8492561.04
 Ortho Height: 705.02
 Ellipsoidal Height: 635.38

Location and Comments

Compass Declination
 20°E

Surveyors Seal

From the junction of Highways 320 and 207, go north 0.6 mile, turn west on a farm road and go 0.6 mile to a cattle guard. The corner is near a railroad tie just north of the cattle guard.

REGISTERED
 PROFESSIONAL
 LAND SURVEYOR

RECEIVED BY:

Firm / Agency

David L. Haddock

Date: 12-02
 Rec'd By: [Signature]
 No.: 02-283-9

Haddock Surveying
 P. O. Box 1574
 Pendleton, OR 97801
 (541) 278-2174

OREGON
 JULY 12, 1968
 DAVID L. HADDOCK
 852