

OREGON CORNER RESTORATION FORM

COUNTY: Umatilla. DATE: 04/18/23.

CORNER DESIGNATION: N-7, the South Quarter Corner of Section 17, Township 3 North, Range 28 East, W.M.

PREVIOUS RENEWALS/SURVEYS ETC: Corner was originally established by N.H. Gates under Contract No. 84, dated July 22, 1859. Gates set a post in earth mound. Survey No. 357, found in Record of Private Survey Books shows a symbol for the corner, which is believed to be a square post set 18" in the ground in 1912. The corner has not been recovered on any later survey.

MONUMENT AND ACCESSORIES FOUND: Found a set stone, 16"X10X8", with top of stone 3" above ground line I find no marks on the stone. The stone is surrounded by 12-15 large stones which were under ground. The found set stone position falls about 4.4' East of a line projected South from the pipe set for the North Quarter corner of Section 17 on Survey No. Q-506-A, through the Center Quarter corner computed on Survey No. 00-33-B.

MONUMENT MARKING DETAIL:

T3N R28E
1 S17
4 S22
2023
PLS 54657

NEW MONUMENT SET:

At the position of the found, set stone, set a 2 1/2" brass cap on 1 1/4 by 30" galvanized iron pipe, 30" in the ground. Set steel fence post, with witness sign attached, 1.5' South of corner. Also attached witness sign to UECA pole #175001 on North side.

New accessories:

- A Silver Deep-1 magnet set 22" below ground line bears N 16°31'21" E, 46.57'.
- A Pink Deep-1 magnet set 22" below ground line bears S 10°49'22" W E, 28.65'.
- A Blue Deep-1 magnet set 22" below ground line bears S 53°06'09" W, 57.98'.
- A 5/8"X24" rebar with blue plastic cap marked "Wells Surveying 54657PLS" bears N 76°19'26" W, 62.10', set in berm between power poles. Wired bearing object to rebar.
- Buried bearing object signs with the Deep-1 magnets.

Courses to corner accessories are State Plane Grid bearings and distances.

LOCATION AND COMMENTS: Corner is South of East-West UECA pole line, about 12' South and 10' East of UECA pole #175001. This pole is in a power pole line running East-West.

OREGON STATE PLANE COORDINATE, North Zone NAD 83(91), International Feet Units:

N: 755667.15
E: 8497856.50

FIRM: Wells Surveying
P.O. Box 1696
Pendleton, OR 97801

Surveyor's Seal

13N28N-7

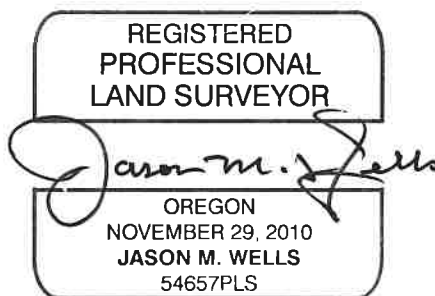

RENEWS: 6:30:24

24-004-C