

OREGON CORNER RESTORATION FORM

COUNTY: Umatilla. DATE: 04/12/23.

CORNER DESIGNATION: N-23, the South Quarter Corner of Section 13, Township 3 North, Range 28 East, W.M.

PREVIOUS RENEWALS/SURVEYS ETC: Corner was originally established by N.H. Gates under Contract No. 84, dated July 22, 1859. Gates set a post in earth mound. The corner area has been surveyed through on several recent surveys but no corner has been reported as found.

MONUMENT AND ACCESSORIES FOUND: None. I reestablished the corner point half-way between the Southwest and Southeast corners of Section 13, holding a segment of existing East-West fence line for latitude.

MONUMENT MARKING DETAIL:

T3N R28E
1 S13
4 S24
2023
PLS 54657

At the point determined by survey, set a 2 1/2" brass cap on 1 1/4 by 30" iron pipe 28" in the ground in an East-West fence line. The monument is marked as shown in monument marking detail.

New accessories:

A 5/8"X24" rebar with blue plastic cap marked "Wells Surveying 54657PLS" bears S 89°36'04" E, 29.14' in East-West fence line. Wired bearing object sign to the rebar.

A 5/8"X24" rebar with blue plastic cap marked "Wells Surveying 54657PLS" bears S 28°57'15" E, 51.60'. Wired bearing object sign to rebar.

A 5/8"X24" rebar with blue plastic cap marked "Wells Surveying 54657PLS" bears S 34°13'32" W, 54.31'. Wired bearing object sign to rebar.

A 5/8"X24" rebar with blue plastic cap marked "Wells Surveying 54657PLS" bears S 89°16'28" W, 38.91', in East-West fence line. Nailed bearing object sign to 3" wood post 6" West of rebar.

Nailed witness sign to 3" wood post 16" West of corner monument..

Courses to corner accessories are State Plane Grid bearings and distances.

LOCATION AND COMMENTS: Corner falls in East-West fence line. Farmed North of fence line and prairie South of fence line.

OREGON STATE PLANE COORDINATE, North Zone NAD 83(91), International Feet Units:

N: 755818.21
E: 8519010.72

FIRM: Wells Surveying
P.O. Box 1696
Pendleton, OR 97801

Surveyor's Seal

\3N28N-23

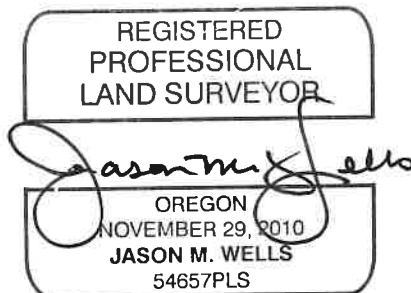

RENEWS: 6.30.24

24-004-C