

**OREGON CORNER RESTORATION FORM**

COUNTY: Umatilla. DATE: 01/17/23.

CORNER DESIGNATION: N-17, the Southeast corner of Section 15, Township 3 North, Range 28 East, W.M.

PREVIOUS RENEWALS/SURVEYS ETC: Corner was originally established by N.H. Gates under Contract No. 84, dated July 22, 1859. Gates set a post in earth mound. Survey No. 357 Map found in Record of Private Survey Books, calls for a stone at this corner. Survey No. H-107-B sets a witness monument for this corner, 15.00 feet South of Corner Point, in 1972. Subsequent record surveys have used the witness monument to compute the corner point.

MONUMENT AND ACCESSORIES FOUND: Found 2 1/2" brass cap on iron pipe witness monument 1 foot South of a 8" round post, stamped as shown in Monument Marking Detail. The cap is stamped with Section 13 rather than Section 14 in the NE quadrant.

**MONUMENT MARKING DETAIL:**

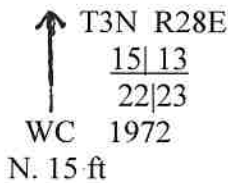

MAINTAINED CORNER MONUMENT: Nailed a Witness Post sign to the round post North of the witness monument. The true corner point falls in an irrigation ditch.

**New accessories, (to the Witness Corner Monument):**

- A 5/8"X24" rebar with blue plastic cap marked "Wells Surveying 54657PLS" bears S 73°17'25" E, 233.55', 1.0' West of UEC power pole no. 3N28E230999. Nailed bearing object sign to pole.
- A 5/8"X24" rebar with blue plastic cap marked "Wells Surveying 54657PLS" bears S 71°08'05" E, 45.35', on South ditch bank. Wired bearing object sign to rebar.
- A 5/8"X24" rebar with blue plastic cap marked "Wells Surveying 54657PLS" bears S 58°29'23" W, 48.23', 1.0' North of UEC power pole no. 3N28E220999. Nailed bearing object sign to pole.
- A 5/8"X24" rebar with blue plastic cap marked "Wells Surveying 54657PLS" bears N 59°41'32" W, 74.11', 1.0' North of 8" round metal gate post. Wired bearing object sign to rebar.

Bearings to corner accessories are State Plane Grid bearings and distances.

LOCATION AND COMMENTS: Witness Corner Monument falls on the South bank of an irrigation ditch.

**OREGON STATE PLANE COORDINATE, North Zone NAD 83(91), International Feet Units:**

N: 755731.90  
E: 8511055.78

FIRM: Wells Surveying  
P.O. Box 1696  
Pendleton, OR 97801

Surveyor's Seal

\3N28N-17

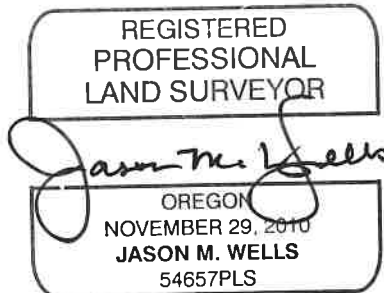

RENEWS: 6!30!24

24-004-C