

**OREGON CORNER RESTORATION FORM**

COUNTY: Umatilla. DATE: 03/22/23.

CORNER DESIGNATION: J-7, the North Quarter Corner of Section 17, Township 3 North, Range 28 East, W.M.

PREVIOUS RENEWALS/SURVEYS ETC: Corner was originally established by N.H. Gates under Contract No. 84, dated July 22, 1859. Gates set a post in earth mound. Survey No. Q-506-A set a 2" pipe for the corner monument. Survey No. 00-33-B recovered the 2" pipe from Survey No. Q-506-A.

MONUMENT AND ACCESSORIES FOUND: Found 2" iron pipe per Survey No. Q-506-A, 4" below ground line. The brass cap witness monument and accessories are as reported on the Survey No. 00-33-B Corner Record. The brass cap witness corner set on Survey No. 00-33-B is stamped as shown in Monument Marking Detail.

MONUMENT MARKING DETAIL FOR WITNESS CORNER ESTABLISHED ON SURVEY NO. 00-33-B:

T3N R28E  
1/4 WC  
S8  
-----  
S17  
2000  
PLS 852

**MAINTAINED CORNER MONUMENT:**

The witness monument accessory has a witness post sign and bearing object sign attached to a railroad tie fence post North of the witness monument. I set a steel fence post 6" West of corner monument with Witness post sign attached.

Courses to corner witness monument and other accessories from Corner Record No. 00-33-B are true bearings and distances.

LOCATION AND COMMENTS: The corner monument is located North of the North driveway to the George Sailing residence.

OREGON STATE PLANE COORDINATE, North Zone NAD 83(91), International Feet Units:

N: 760969.97  
E: 8497733.46

FIRM: Wells Surveying  
P.O. Box 1696  
Pendleton, OR 97801

Surveyor's Seal

\3N28J-7

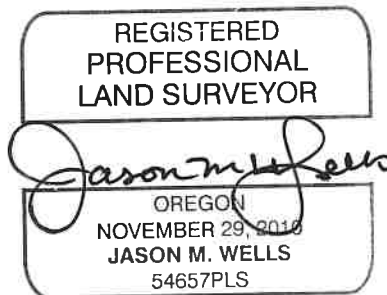

RENEWS: 6.30.24

24-004-C