

OREGON CORNER RESTORATION FORM

COUNTY: Umatilla. DATE: 03/29/23.

CORNER DESIGNATION: J-21, the Northeast corner of Section 14, Township 3 North, Range 28 East, W.M.

PREVIOUS RENEWALS/SURVEYS ETC: Corner was originally established by N.H. Gates under Contract No. 84, dated July 22, 1859. The corner area was surveyed through on Survey No. 2262, found in Record of Private Survey Books and a stone, 16”X8”X5” was reestablished for the corner point. The corner was re-established on Partition Plat No. 1997-17 and a bridge spike was set at the intersection of centerlines of and East-West Road, a fence extending North and a lane extending South.

MONUMENT AND ACCESSORIES FOUND: Found a bridge spike per Partition Plat No. 1997-17, 8” below the road surface of a chip sealed road.

MONUMENT MARKING DETAIL:

T3N R28E
S11 | S12

S14 | S13
2023
PLS 54657

NEW MONUMENT SET:

At the position of the found bridge spike, set a 5/8”X24” rebar with 2” aluminum cap, marked as shown in Monument marking detail. The aluminum cap is 3” below the road surface and was surrounded by concrete for additional stability.

New accessories:

Note: The property owner requested no accessory in the NE quadrant.

- A 5/8”X24” rebar with blue plastic cap marked “Wells Surveying 54657PLS” bears S 79°22’15” E, 93.89’, 6” North of wood fence post in East-West fence. Wired bearing object sign to the rebar.
- A 5/8”X24” rebar with blue plastic cap marked “Wells Surveying 54657PLS” bears S 62°20’04” E, 38.39’, at wood fence corner post of driveway to the South Wired bearing object sign to rebar.
- A 5/8”X24” rebar with blue plastic cap marked “Wells Surveying 54657PLS” bears S 58°18’11” W, 36.34’, at wood fence corner post of driveway to the South Nailed Witness post sign and bearing object sign to the wood post.
- A 5/8”X24” rebar with blue plastic cap marked “Wells Surveying 54657PLS” bears N 69°57’48” W, 36.11’, 6” South of steel fence post in East-West fence. Wired bearing object sign to the rebar.

Courses to corner accessories are State Plane Grid bearings and distances.

LOCATION AND COMMENTS: The corner monument is located 3” below the road surface of an East-West chip sealed road. (Andrews Road).

OREGON STATE PLANE COORDINATE, North Zone NAD 83(91), International Feet Units:

N: 761104.84
E: 8516272.25

FIRM: Wells Surveying
P.O. Box 1696
Pendleton, OR 97801

Surveyor's Seal

\3N28J-21

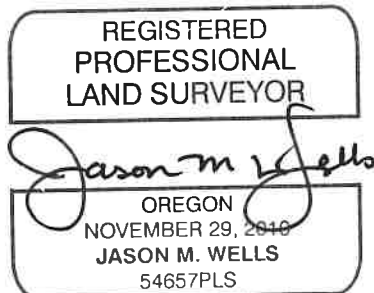

24-004-C

RENEWS: 6/30/24