

CORNER RESTORATION FORM

Township 3N Range 28E Section 6 County UMATILLA

State OREGON Date 12/21/12 Number E3

Corner Designation : SOUTH 1/4

- Condition Report Only
- Not Found
- Renewed
- Surveyed In
- Referenced

Previous Renewals _____

Monument (s) Found: (Condition and Source)

FOUND 3/4 INCH (SMOOTH) IRON ROD

NO RECORD OF THIS MONUMENT COULD BE FOUND

BUT APPEARS TO HAVE BEEN ACCEPTED IN THE

PAST AND I THEREFOR HELD IT POSITION.

MONUMENT DETAIL

Found Set

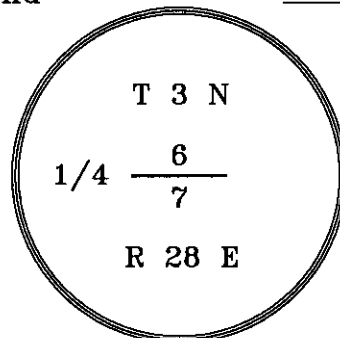

DETAIL FOR REFERENCE ONLY,

Accessories Found: _____

A FADED UMATILLA COUNTY SURVEYOR WITNESS POST SIGN ON A LEANING RAILROAD TIE FENCE BRACE POST 0.5 FT. NORTH OF MONUMENT.

Sketch of Monument, Accessories and General Area

SEARCH AREA IS NEAR SOUTHERLY MOST POLE OF LARGE N-S OVERHEAD POWERLINE

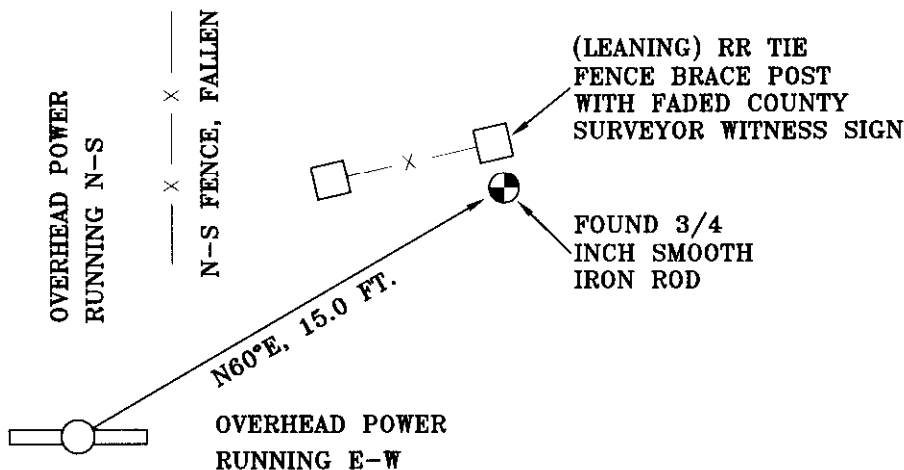

MONUMENT LIES N60°E, 15.0 FT. FROM FACE OF SOUTHERLY MOST POWER POLE

REGISTERED PROFESSIONAL LAND SURVEYOR

Danny K. Cummings

OREGON
JAN. 21, 1988
DANNY K. CUMMINGS
2316

RENEWAL DATE : 12-31-13

Agency CK3, LLC.
945 S.W. ORCHARD AVE., HERMISTON OR

Party Chief Rod Lewis
Notekeeper Rod Lewis
Witness(s) _____
Field Book 0-287
Client Cascade Natural Gas
Job # V0-12051

COUNTY SURVEYOR RECORDING INFO

Received 2/1/2013
Filed S. Res
Survey No. 13-015-C
Drawing No. _____
Index No. E-3