

OREGON CORNER RESTORATION FORM

COUNTY: Umatilla. DATE: 04/26/23.

CORNER DESIGNATION: C-21, the East Quarter Corner of Section 2, Township 3 North, Range 28 East, W.M.

PREVIOUS RENEWALS/SURVEYS ETC: Corner was originally established by N.H. Gates under Contract No. 84, dated July 22, 1859. Gates set a post in earth mound. Survey No. 253, found in Record of Private Survey Books indicates the corner was reestablished and monumented with a "post and stone". Survey No. 253 also established and monumented the North and South 1/16 the corners on this line and monumented with "posts". I note that on Survey No. 253, the surveyed line was divided into 4 equal parts and monumented rather than considering the fractional dimensions reported by N.H Gates, the original surveyor. I cannot determine any features in the corner area on the 1956 aerial photos.

MONUMENT AND ACCESSORIES FOUND: None. I searched for the 1/4 corner stone and did not recover it.

MONUMENT MARKING DETAIL:

T3N R28E
1/4
S 2 | S1
2023
PLS 54657

I computed the corner point by single proportion measure between the Northeast and Southeast corners of Section 2 using the original N.H. Gates record. Within 2' of the computed corner point, I find a fence corner with fence lines extending North-South and Northeast. The fence corner is a rotted off railroad tie. I accept the railroad tie fence corner as the best remaining evidence of the original corner and at a point just East of the railroad tie fence corner, set a 2 1/2" brass cap on 1 1/4" by 30" galvanized iron pipe, 28" in the ground. The corner monument is stamped as shown in Monument Marking Detail. Set a wood fence post 1' South of corner and attached witness sign.

New accessories:

- A 5/8"X24" rebar with blue plastic cap marked "Wells Surveying 54657PLS" bears N 00°46'06" W, 81.93', in N-S fence line. Wired bearing object sign to fence post near rebar.
- A 5/8"X24" rebar with blue plastic cap marked "Wells Surveying 54657PLS" bears N 00°39'43" W, 30.30', in N-S fence line. Nailed bearing object sign to wood post near rebar.
- A 5/8"X24" rebar with blue plastic cap marked "Wells Surveying 54657PLS" bears S 00°10'56" E, 38.24', in N-S fence line. Nailed bearing object sign to wood fence post near rebar.
- A 5/8"X24" rebar with blue plastic cap marked "Wells Surveying 54657PLS" bears N 70°24'01" E, 45.95', in fence line extending NE from the corner point. Wired bearing object sign to fence post near the rebar.

Courses to corner accessories are State Plane Grid bearings and distances.

LOCATION AND COMMENTS: Corner monument is located in a North-South fence line at a fence corner where a fence extends Northeasterly.

OREGON STATE PLANE COORDINATE, North Zone NAD 83(91), International Feet Units:

N: 769071.03
E: 8516139.60

FIRM: Wells Surveying
P.O. Box 1696
Pendleton, OR 97801

Surveyor's Seal

\3N28C-21

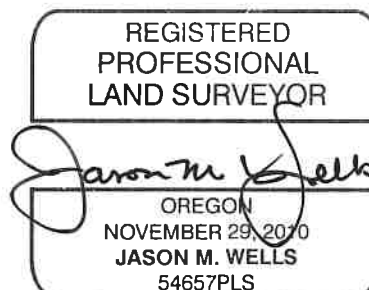

RENEWS: 6.30.24

24-004-C