

OREGON CORNER RESTORATION FORM

Section 5 Township 3N Range 28E
 County Umatilla Date: 06-14-02

Corner Designation: 3N28A5

Condition Report Only
 Not Found
 Remonumented
 Unrecorded
 Surveyed In
 Referenced Out

Previous Renewals / Surveys, etc.

Survey Q-503-B reported finding a stone here.
 Survey S-156-C reported setting a brass capped monument here.

Monument and Accessories Found: (condition and source)

Found a brass capped monuments as described below.

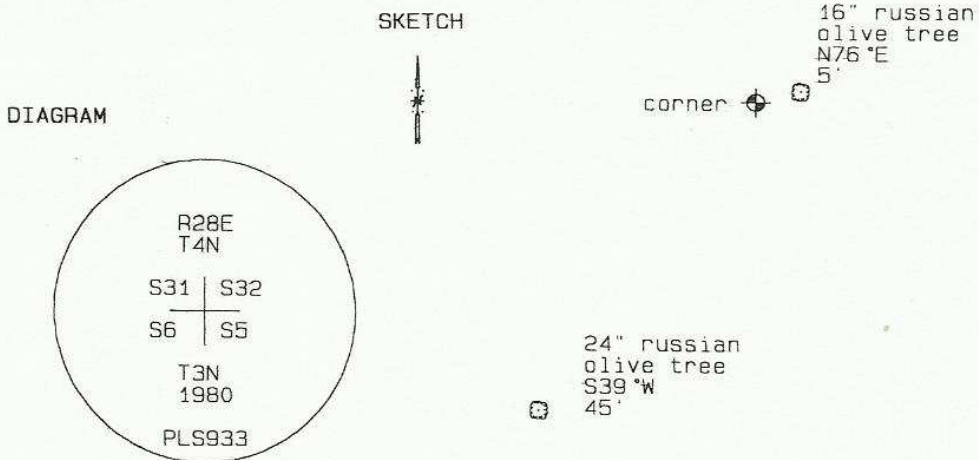

MONUMENT (S) AND ACCESSORIES SET (Procedures and Description)

None.

REFERENCES SET:

None.

Made GPS tie to TRI Station	Oregon State Plane Coord. - North Zone
Stanfield East Base	Northing 771587.69
Latitude 45°46'38.41072" N	Easting 8494804.50
Longitude 119°21'09.98299" W	Ortho Height 575.33
NAD 83 (1991)	Ellipsoidal Height 505.42

Location and Comments Compass Declination Surveyors Seal

From the junction of I84 and the Westland Road, south 0.5 miles on Col. Jordan Road to Getchell Road. Go 1.0 mile east on Getchell Road and turn south on a field road about 0.4 mile. Walk southeast into a low area where there are two Russian olive trees. The corner is between these two trees.

RECEIVED BY:

Firm / Agency
 Haddock Surveying
 P. O. Box 1574
 Pendleton, OR 97801
 (541) 276-2174

REGISTERED
 PROFESSIONAL
 LAND SURVEYOR

David L. Haddock

OREGON
 JULY 12, 1968
 DAVID L. HADDOCK
 852

Date: 7-02
 Rec'd By: ZE
 No. 02-185-9