

OREGON CORNER RESTORATION FORM

Section 1 Township 3N Range 27E
 County Umatilla Date: 06-29-02

Corner Designation: 3N27E23
 Condition Report Only
 Not Found
 Remonumented
 Unrecorded
 Surveyed In
 Referenced Out

Previous Renewals / Surveys, etc.
 Survey 90-49-B records finding a 1940 GLO brass capped monument here.
 Survey 95-54-B records finding a 1940 GLO brass capped monument here.

Monument and Accessories Found: (condition and source)

Found the described GLO brass capped monument as described south of the east end of a steel farm building.

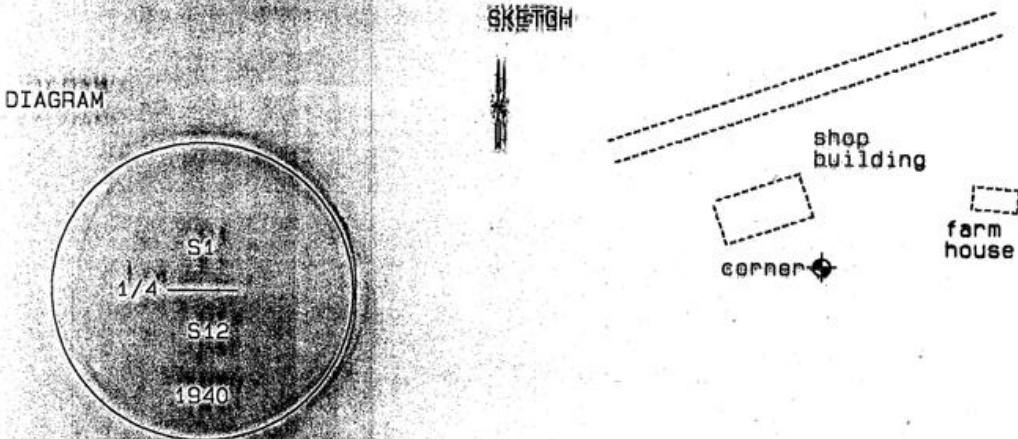

MONUMENT (S) AND ACCESSORIES SET (Procedures and Description)

None

REFERENCES SET

None
 Made GPS tie to TBI Station
 Stanfield East Base
 Latitude 45 25 45 5662.11 N
 Longitude 119 22 58 57502.11 W
 NAD 83 (1991)

Oregon State Plane Coord. - North Zone
 Northing 766231.35
 Easting 8487181.37
 Ortho Height 702.81
 Ellipsoidal Height 632.94

Location and Comments

Compass Declination 20°E

Surveyors Seal

From the junction of 164 and Westland Road, go south on Coll. Jordan Road 1.1 mi. Then take the Madison Ranch Road south 0.6 mile and south westerly 0.6 mile. The corner is on the south side of the farm shop building.

REGISTERED PROFESSIONAL LAND SURVEYOR

RECEIVED BY:

Firm / Agency

David L. Haddock

Date: 12-02
 Rec'd By: KK
 No: 02-282-9

Haddock Surveying
 P. O. Box 1574
 Pendleton, OR 97801
 (541) 276-2174

OREGON
 JULY 12, 1968
 DAVID L. HADDOCK
 852