

USDA-FOREST SERVICE

Index
File No. R 23
T 25 R. 34E
Merid. Will

CORNER RECORD (SEARCH)

(Ref. FSM 7151.4)

Tract or Survey No. _____ Cor. No. _____

R.D. Ukiak County Umatilla
N.F. Umatilla State Oregon

CORNER DIAGRAM

T25 R34E

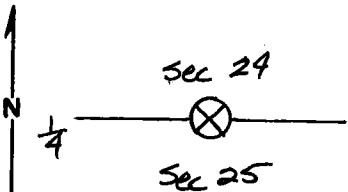

DESCRIBE CORNER MONUMENT FOUND

Found outcrop of basalt, 5ft high, 10ft E-W, with no visible marks, but with mound of stones on top.

DESCRIBE BEARING TREES OR OTHER OFFICIAL ACCESSORIES FOUND

Orig. 12" pine is now down and decayed with scribes visible on piece of face and bears $523^{\circ}E$, 66 ft from corner.
Orig. 24" pine is alive with double, healed blazes and bears $N60^{\circ}E$, 109.5 ft from corner.

PHOTO IDENTIFICATION DATA

Photo No. _____
Filed At. _____
Object Ident. _____
Ident. By _____
Signature

PLANE COORDINATE POSITION DATA

State _____ Zone _____
X _____
Y _____
Estab. By _____
Agency

DESCRIBE CORNER LOCATION RELATIVE TO NEAR-BY FEATURES, ALSO HOW TO REACH CORNER

Signature Dennis L. Gaylord Title _____ Division PLS 1636 Headquarters _____ Date 6-14-84

7100-52 (3-68)

CORNER RECORD (PERPETUATION)

MONUMENT: DESCRIBE NEW MONUMENT SET, OR WORK DONE TO PRESERVE EXISTING MONUMENT

ACCESSORIES : DESCRIBE NEW BT'S WITNESS OBJECTS ETC. ESTABLISHED, OR WORK DONE TO PRESERVE EXISTING EVIDENCE

Work Done By. _____ Title _____ Date _____ State Registration No. _____
or Agency _____

Certified Cor. Record Prepared ? Yes No Filed At: _____ Date _____

REMARKS

Index File No. T. R. M. Tract or Surv. No. Cor.