

OREGON CORNER RESTORATION FORM

Section 32 Township 2S Range 33E
 County Umatilla Date: May 20, 2000

Corner Designation: 2S33Z9

Closing corner to sections 32 and 33, T2S, R33E,
 W.M., Umatilla County, Oregon.

Condition Report Only
 Not found
 Remonumented
 Unrecorded
 Surveyed in
 Referenced out

Previous Renewals / Surveys, etc.

Corner originally set by John C. Arnold under contract #551 dated March 19, 1890.
 His record reads: Set basalt stone, 18 x 10x 3 ins., 12 ins. in ground for cor. to secs. 32 and 33,
 marked with 4 notches on E. face and 2 notches on W. face, CC on north., Raised mound of
 stone 2 ft. high x 4 ft. base over corner from which:
 A fir, 10 ins. diam. brs. N65°W, about 100 lks. dist., marked T2S R33E S32BT.

Monument and Accessories found: (condition and source)

A live, 32" dbh fir, with plainly visible scribing with a USFS location poster attached.

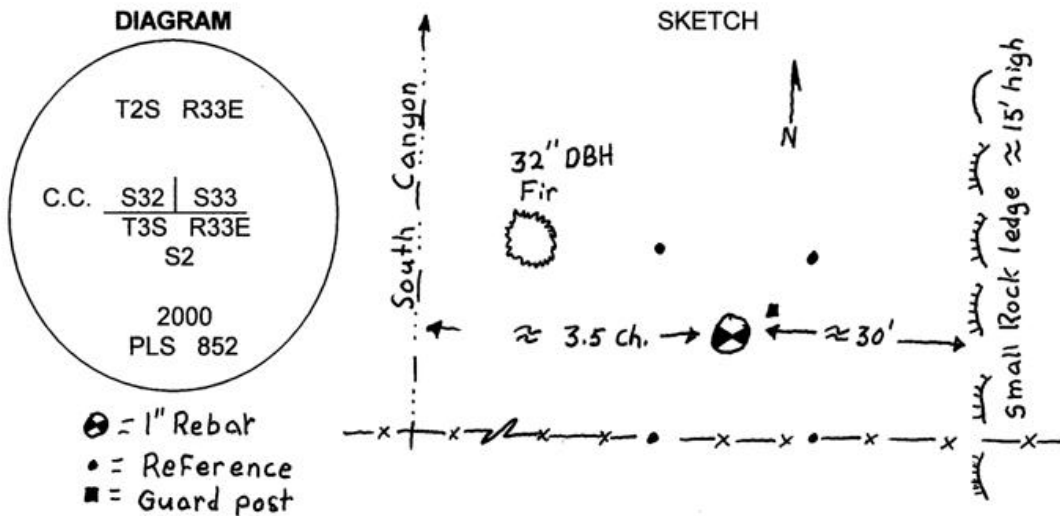

MONUMENT (S) AND ACCESSORIES SET (Procedures and Description)

Set a 1" x 24" iron rebar with a 2" aluminum cap stamped as shown in the diagram above at the record bearing and distance from the bearing tree. Set a 6' steel post with a county monument sign attached along side. The pin falls in a visible mound but I could not locate the marked stone.

For references, I set four, 5/8" by 24" rebars with 2.5" red plastic caps stamped ORLS 852, WALSH 13922, and HADDOCK SURVEYING as described below:

- an iron rebar bears N22°26'04"W, 30.45 feet;
- an iron rebar bears N25°06'33"E, 26.91 feet;
- an iron rebar bears S56°44'08"W, 17.48 feet;
- an iron rebar bears S54°17'06"E, 17.90 feet;

The monument and references were tied using a LIECA system 300 RTK GPS.

Location and comments

Compass Declination

Surveyors Seal

RECEIVED BY:
 Umatilla County Surveyor
 Date: 7-00
 Rec'd By: KK
 No. 00-156-C

Firm / Agency
 Haddock Surveying
 Address
 P.O. Box 1574
 Pendleton, Or. 97801
 Party Chief
 Stephen K, Haddock

REGISTERED
 PROFESSIONAL
 LAND SURVEYOR

David L. Haddock

OREGON
 JULY 12, 1988
 DAVID L. HADDOCK
 852