

USDA-FOREST SERVICE

CORNER RECORD (SEARCH)
(Ref. FSM 7151.4)

Tract or Survey No. _____ Cor. No. R-1

Index File No. R-1

T 2 N R. 38 E

R.D. Pendleton County _____

Merid. _____

N.F. Umatilla State _____

CORNER DIAGRAM

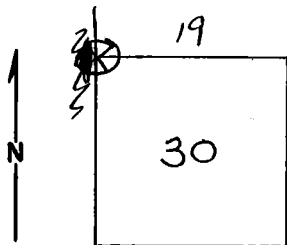

DESCRIBE CORNER MONUMENT FOUND

Material: Fir Tree Size: 30" diam.
Height Above Ground: Windfall
Markings: Closed blazes - 4 sides

DESCRIBE BEARING TREES OR OTHER OFFICIAL ACCESSORIES FOUND 2

SE Quad. - 20" Pine, down beside corner tree with blaze up, scribed: T2N R38E S 30 BT
SW Quad. - 14" Fir down, blaze up with faint scribing.
NE Quad. - 12" down, rotten Fir blazed underneath with faint scribing.
NW Quad. - Fir stump at correct bearing and approx. dist. ~~from~~ ^{for} BT.

DESCRIBE CORNER LOCATION RELATIVE TO NEAR-BY FEATURES, ALSO HOW TO REACH CORNER 3

PHOTO IDENTIFICATION DATA

Photo No. _____
Filed At. _____
Object Ident. _____
Ident. By _____

Signature 7

PLANE COORDINATE POSITION DATA

State _____ Zone _____
X _____
Y _____
Estob. By _____

Agency 8

Signature

B. Moore

Title

Division

Headquarters

7-5-79

Date

7100-52-(3/68)

4

5

CORNER RECORD (PERPETUATION)

MONUMENT: DESCRIBE NEW MONUMENT SET, OR WORK DONE TO PRESERVE EXISTING MONUMENT

ACCESSORIES : DESCRIBE NEW BT'S WITNESS OBJECTS ETC. ESTABLISHED, OR WORK DONE TO PRESERVE EXISTING EVIDENCE

I placed BT posters on all of the down bearing trees and an Attention poster on the down corner tree.
Also put up location poster on Ruckel Road 1740' South of corner.

Work Done By _____ Title _____ Date _____ State Registration No. or Agency _____

Certified Cor. Record Prepared? Yes No Filed At: _____ Date _____

REMARKS

Index File No. T. R. M. Tract or Surv. No. Cor. U.S. G.P.O. 1977-725-576/586