

Form 874-9—Revised May, 1918

U. S. Department of Agriculture

FOREST SERVICE

Umatilla NATIONAL FOREST ✓

CORNERS OF THE PUBLIC SURVEY

T. 2 N R. 37 E W Mer.

Section Corner common to Sections

13, and 24

Corner consists of a Stake rotted (not) in place

State condition and gone.

Dimensions above ground _____ inches.

Sketch grooves, letters, figures, or notches, on proper face or edge.

CARDINAL POSITION			
N	W	S	E

DIAGONAL POSITION			
NW	SW	SE	NE

Mound of _____ is located _____

Pits are located _____

Sketch markings of Bearing Trees (or Rocks) in proper box and fill blanks below, giving bearings from Corner to Trees and Distances in Links.

<u>T2N</u>			
<u>R37E</u>			
<u>S13</u>			
<u>BT</u>			

Species WF

Diameter 20 in

Bearing ?

Distance ?

Do you believe this to be a genuine Land Office Corner? _____

If not, why? Corner was probably a stake and has been destroyed by the elements.

Gerald J. Lusk
(Signature)

9-23-30
(Date)

Forest Ranger
(Title)

T. 2 N R. 37 E W Mer.

(Make sketch of topography near Corner)

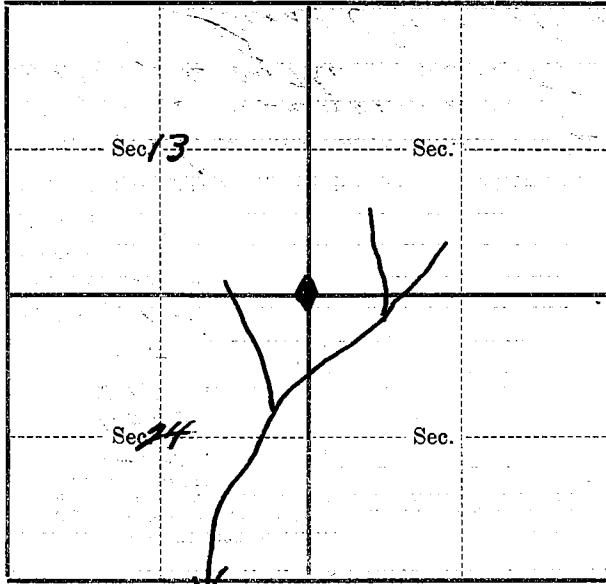

Metal Location Poster is on a Y.P.
tree 18 inches diameter, on the North
side of Corner
from which this Corner bears South 10° W
One chains distant.

Give any further facts which will aid in finding this
Corner again.

Near the headwaters of
Willow Creek on Township
line between Township
2 North and Range 37 and
38 E.N.M. East of course &
about 100 yds from creek