

CERTIFIED RECORD OF LAND CORNER MONUMENTATION

History of original corner establishment:

Corner originally established by Charles L. Campbell under GLO contract number 733, dated March 22, 1901. Surveyor General record states:

At the point of intersection, I set a basalt stone 18x10x5 ins. 12 ins in the ground for closing cor. of secs. 2 and 3, marked CC on S., 2 grooves on E., and 4 groove on W. faces; from which;

A Fir, 12 ins diam bears S11°E, 25 lks dist marked T2N R37E S2 BT
A Fir, 12 ins diam bears S25°W, 19 lks dist marked T2N R37E S3 BT

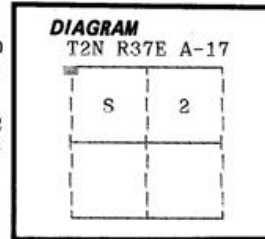

No record of subsequent monumentation found in Umatilla County survey records.

Description of corner evidence found:

Found no evidence of the original corner monument.

Found a 14 inch diameter fir snag S25°W, 19 lks with scribes visible.

Found no evidence of the original Southeast bearing tree.

Description of monument and accessories I established to perpetuate the

original location of this corner: At record bearing and distance from the found original bearing tree, I set a 2 1/2" x 30" aluminum pipe with aluminum cap marked as shown, 24 inches in the ground, from which:

New Bearing Trees and Bearing Objects:

A 15 inch diameter Douglas Fir bears N32°E, 15.81 feet marked X BT
A 5/8"x30" iron pin with plastic cap marked BGA SURVEY MARKER bears S45°E, 4.29 feet
A 12 inch diameter Douglas Fir bears S71°W, 49.71 feet marked T3N R37E S3 BT
A 6' steel fence post bears East, 3.22 feet with Land Survey Monument sign attached

Attached Bearing Tree and Land Survey Monument signs to BTs

I find this corner position to be 10.30 feet North of the Township line as determined by my survey.

I hereby certify that the above corner point was perpetuated as hereon described on June 28, 1991.

Witnesses: Jeff Petersen and Jim Bennett

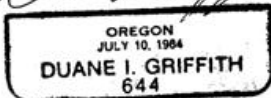
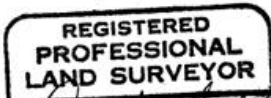

I used a steel tape and magnetic compass in the establishment of new accessories. I used 20° East magnetic declination and the distances are to a 50d spike driven in the right side of the root crown. I attached a brass washer marked OPLS 644 to the BT blaze.

Office of..... County of.....
State of....., I hereby certify that the within instrument was filed in this office for record on the..... day of....., 19....
..... by
(COUNTY OFFICIAL) (DEPUTY)

Form R6-7100-57 (9/71)

RECEIVED BY
Umatilla County Surveyor
A-17 Date 10-92
Rec'd By KK
No. 92-119-R