

Index  
File No. A-25

**CORNER RECORD (SEARCH)**

Tract or Survey No. \_\_\_\_\_ Cor. No. \_\_\_\_\_

T 2N R. 36E  
Merid. W.M.

R.D. Pendleton County Umatilla  
N.F. Umatilla State Oregon

**CORNER DIAGRAM**

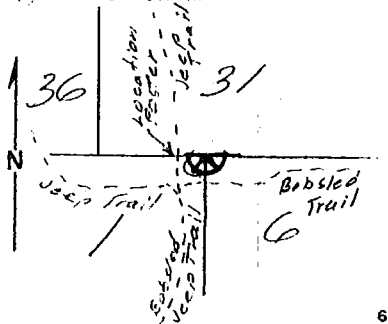

DESCRIBE CORNER MONUMENT FOUND: A 15x12x8 in. basalt stone marked with a CC on south face with 6 grooves on S, E & W faces as described in original notes.

**DESCRIBE BEARING TREES OR OTHER OFFICIAL ACCESSORIES FOUND**

Found S E BT, now a 90" Fir Dead but standing, face scribed as in original notes.

B.T. is S 45° E 39 lks. from corner not 28 lks as described in original notes.

Large dead Fir tree found laying across stone marked as section corner believed to be SW BT (laying on face)

**PHOTO IDENTIFICATION DATA**

Photo No. EQD 10-291  
Filed At. Pendleton R.D.  
Object Ident. Stone & BT  
Ident. By Umatilla Dist. Comm.  
Signature \_\_\_\_\_

**DESCRIBE CORNER LOCATION RELATIVE TO NEAR-BY FEATURES, ALSO HOW TO REACH CORNER**

corner is located about 3 chains East of Jeep trail on end of Bobsled ridge.

**PLANE COORDINATE POSITION DATA**

State \_\_\_\_\_ Zone \_\_\_\_\_  
X \_\_\_\_\_  
Y \_\_\_\_\_  
Estab. By \_\_\_\_\_  
Agency \_\_\_\_\_

Signature

Title

Division

Headquarters

Date

7100-52 (3/68)

*Umatilla N.P.C.*

*Civil Eng. Tech. Eng.*

*Pendleton*

*9-20-78*

A-25

CORNER RECORD (PERPETUATION) T2N R36E

MONUMENT: DESCRIBE NEW MONUMENT SET, OR WORK DONE TO PRESERVE EXISTING MONUMENT

cut and removed part of large dead tree lying across corner and painted stone Red.

9

ACCESSORIES : DESCRIBE NEW BT'S WITNESS OBJECTS ETC. ESTABLISHED, OR WORK DONE TO PRESERVE EXISTING EVIDENCE

SE BT dead so cut it to about 5' stump. Cut out face to scribing. Painted top of stump Red and two red bands. Placed a location poster on the SE BT marked sec. cor. 39 Lks. N45°00' sec. 6 T2 R37E.

10

Work Done By V.H. Poe Title Civil Eng. Tech. Date 9-14-72 State Registration No. or Agency U.S. Forest Serv.

Certified Cor. Record Prepared? Yes  No  Filed At: \_\_\_\_\_ Date \_\_\_\_\_

11

REMARKS

12