

## CORNER RECORD (SEARCH)

(Ref. FSM 7151.4)

Tract or  
Survey No.Cor.  
No.Index  
File No. N-21T 2N R. 36ER.D. Pendleton County \_\_\_\_\_Merid. Will.N.F. Umatilla State Oregon

## CORNER DIAGRAM

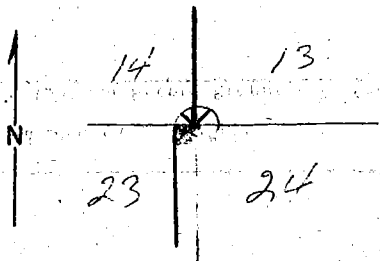

## DESCRIBE CORNER MONUMENT FOUND

Mount of stone

## DESCRIBE BEARING TREES OR OTHER OFFICIAL ACCESSORIES FOUND

1 B.T. about 78' @ 336° from corner  
(18' ponderosa pine snag).

## PHOTO IDENTIFICATION DATA

Photo No. \_\_\_\_\_

Filed At. \_\_\_\_\_

Object Ident. \_\_\_\_\_

Ident. By \_\_\_\_\_

Signature

## PLANE COORDINATE POSITION DATA

State \_\_\_\_\_ Zone \_\_\_\_\_

X \_\_\_\_\_

Y \_\_\_\_\_

Estab. By \_\_\_\_\_

Agency

Signature

HardmanTitle Forester Division U.S.F.S. Headquarters Pendleton

Date

8-5-75

7100-52 (3/68)

CORNER RECORD (PERPETUATION)

MONUMENT: DESCRIBE NEW MONUMENT SET, OR WORK DONE TO PRESERVE EXISTING MONUMENT

Guard of stone painted red with 3 glow top stakes placed around it, and flagged with fluorescent red ribbon.

ACCESSORIES: DESCRIBE NEW BT'S WITNESS OBJECTS ETC. ESTABLISHED, OR WORK DONE TO PRESERVE EXISTING EVIDENCE

B.T. was marked with red band and painted face, and with poster #54-3.

Work Done By Hardman Title Forester Date 2-1-75 State Registration No. \_\_\_\_\_ or Agency \_\_\_\_\_

Certified Cor. Record Prepared? Yes  No  Filed At: \_\_\_\_\_ Date \_\_\_\_\_

REMARKS