

OREGON CORNER RESTORATION FORM

COUNTY: Umatilla DATE: 08/01/07

CORNER DESIGNATION: 2N34, A21. The Northwest Corner of Section 1.

PREVIOUS RENEWALS/SURVEYS ETC.:

Corner was established by Currin and Noland under Special Contract dated May 4, 1887. The previous survey, by Moody, Contract No. 145, was superseded by the Currin and Noland Survey. Currin and Noland's notes state: "set post, 4 ft long and 4 ins square, 24 ins in the ground for corner to secs 1 & 2, marked CC T2N., R34E on S, S1 on E, and S2 on W faces, with 1 notch on East and 5 notches on West faces. Dug pits 18 x 18 x 12 ins SE & W of post, 5 1/2 ft. dist., raised mound of earth 2 ft high 4 ft at base, around corner". Corner was not recovered by Redfield in his survey circa 1918-1919 and was re-established by proportional methods, between the Southeast Corner of Section 36 and the Southwest Corner of Section 35. Redfield's notes do not state what was set as a corner monument.

MONUMENT AND ACCESSORIES FOUND: None. Corner falls in wheat field.

MONUMENT MARKING DETAIL:

T3N R34E
S36
S2|S1
CC
2007
PLS 1106

MONUMENT SET:

Corner was re-established corner by proportionate measure between the recovered Redfield monuments at the East 1/16th Corner of Section 36 and the Southwest Corner of Section 36, using the Redfield record. At the re-established corner position, set a 2 3/8" brass cap on 1 1/4" x 30" galvanized iron pipe with cap 20" below ground level. Monument marked as shown in monument marking detail.

New accessories:

A Silver Deep-1 magnet buried 18" below ground level bears North 43 1/2° East, 27.9 feet.
A Blue Deep-1 magnet buried 18" below ground level bears South 48° East, 32.4 feet.
A Pink Deep-1 magnet buried 18" below ground level bears South 53 1/2° West, 31.1 feet.
A Orange Deep-1 magnet buried 18" below ground level bears North 48° West, 26.7 feet.
Buried bearing objects signs with all Deep-1 magnets. Set steel fence post with "witness" sign attached 2 feet East of corner monument.

LOCATION AND COMMENTS: Corner is located in a wheat field.

OREGON STATE PLANE COORDINATE, North Zone, NAD 83(91), International Feet:

N = 743152.83
E = 8708826.34

FIRM: William R. Wells, PLS
P.O. Box 1696
Pendleton, OR 97801

COMPASS DECLINATION: 18° East

Surveyor's Seal

Witnesses: Jason Wells, LSIT

2N34A21

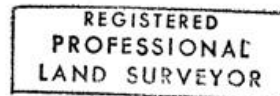

William R. Wells

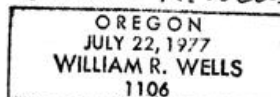

renews 6-30-08