

CERTIFIED RECORD OF LAND CORNER MONUMENTATION

LOCATED: In the ~~NE 1/4~~ SE 1/4 Sec. 9, T. 2 N. R. 32 EWM

History of original corner establishment:

Reservation Boundary # 2

Chiseled cross on stone monument.

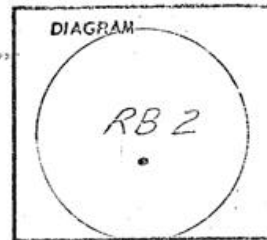
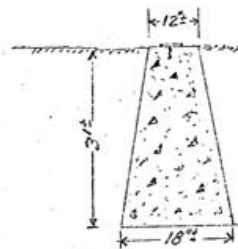

OSHD Reference Brass cap

Description of corner evidences found:

Chiseled cross on stone monument buried approximately three feet under roadway.

Description of monument and accessories established to perpetuate the

original location of this corner. New monument is a brass cap set in concrete. Brass cap is stamped RB 2 with punch mark below. Marker denoting monument location is set adjacent. Monument set from cross sights set from orig. stone before it was buried. the orig. stone is buied approx. 20' under the surface mark.

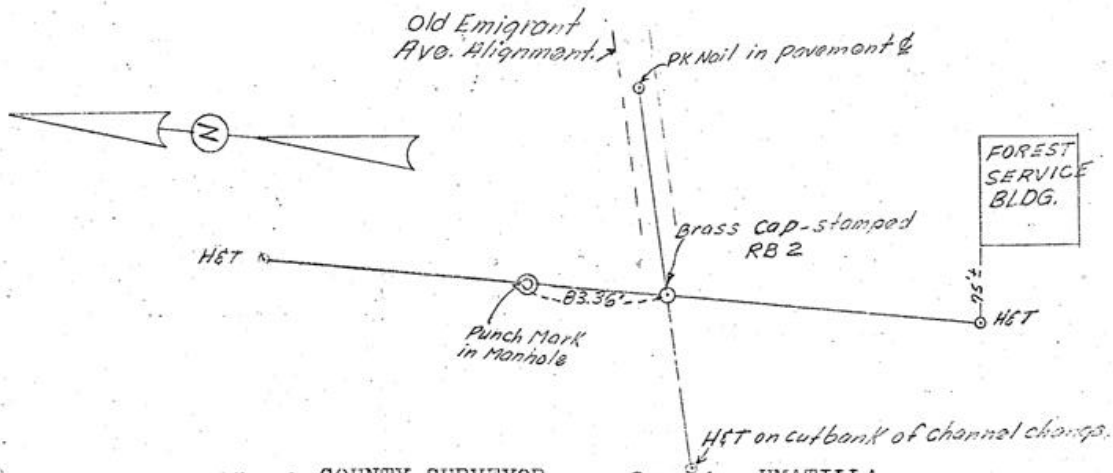

Office of COUNTY SURVEYOR County of LAMARILLIA State of OREGON, I hereby certify that the within Instrument was filed in this office for record on the 6 day of FEBRUARY, 1970, at o'clock m., (signed) Ralph Thompson by \_\_\_\_\_ (COUNTY OFFICIAL) (DEPUTY)

