

OREGON CORNER RESTORATION FORM

SECTION: 24 TOWNSHIP: 2N RANGE: 29E R-25

COUNTY: UMATILLA DATE 8/2010

CORNER DESIGNATION

SE 24

- CONDITION REPORT ONLY
- NOT FOUND
- RENEWED
- UNRECORDED
- SURVEYED IN
- REFERENCED OUT

PREVIOUS RENEWALS/SURVEYS ETC.

Originally surveyed by Thompson under Contract #83 in 1859. He set post and made mound.

MONUMENTS AND ACCESSORIES FOUND: CONDITON AND SOURCE

Nothing Found

MONUMENT DETAIL

T2N
 R29E R30E
 24| 19
 25| 30
 2007
 LS 951

OREGON STATE PLANE COORDINATES NORTH ZONE, NAD 83(91), Int Feet:

719522.04
8554582.48

MONUMENT SET (PROCEDURES AND DESCRIPTION)

In a fence line for Eastings and by proportion for Northings I set a 2 3/8" brass cap on a 1" x 30" iron pipe at ground level stamped as above.

NEW ACCESSORIES FROM WHICH

- A 5/8" x 30" Iron Rebar with plastic cap #951 bears N 0° 12' 40" W 63.46'
 - A 10" bridge spike and an orange mag. 24" deep bears N 88° 18' 56" E 26.26'
 - A 5/8" x 30" Iron Rebar with plastic cap #951 bears S 0° 01' 00" W 50.89'
 - A 10" bridge spike and pink mag. bears S 87° 15' 05" W 19.97'
- These bearings and distances are State Plane.

LOCATION AND COMMENTS

From Cunningham sheep ranch shop go southwesterly on Cunningham Road 2.5 miles to fork. Take left fork and left fork 2.5 miles. Corner lies .6 mile east of road in a N-S fence line.

FIRM: EDWARDS SURVEYING LLC
PO BOX 763 - HERMISTON OR 97838

PARTY CHIEF: G. EDWARDS
WITNESS: R. SMITH

SURVEYOR'S SEAL

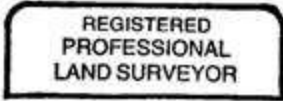

G. Dennis Edwards

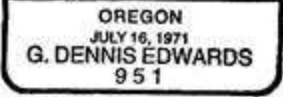

RENEWS 12/31/11