

OREGON CORNER RESTORATION FORM

SECTION: 18 TOWNSHIP: 2N RANGE: 29E L-1

COUNTY: UMATILLA DATE: 6/2010

CORNER DESIGNATION

W ¼ 18

- CONDITION REPORT ONLY
- NOT FOUND
- RENEWED
- UNRECORDED
- SURVEYED IN
- REFERENCED OUT

PREVIOUS RENEWALS/SURVEYS ETC.

Originally surveyed by Thompson under Contract #83 in 1859. He set post and made mound.
In 1980 Terry Hamby set a 2 ½" brass cap.

MONUMENTS AND ACCESSORIES FOUND: CONDITON AND SOURCE

Found Hamby's 2" iron pipe with the brass cap missing.

MONUMENT DETAIL

T2N
R28E R29E
¼
13|18

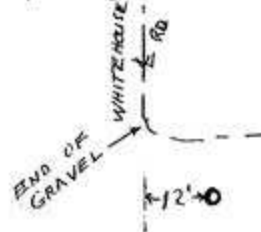

OREGON STATE PLANE COORDINATES NORTH ZONE, NAD 83(91), Int Feet:

726613.55
8522109.58

MONUMENT SET (PROCEDURES AND DESCRIPTION)

NEW ACCESSORIES FROM WHICH

- A 5/8" x 30" Iron Rebar with plastic cap #951 bears N 3° 54' 06" E 225.70'
 - A 5/8" x 30" Iron Rebar with plastic cap #951 bears N 84° 48' 40" W 30.48'
 - A 5/8" x 30" Iron Rebar with plastic cap # 951 bears S 31° 17' 35" E 27.07'
 - A 5/8" x 30" Iron Rebar with plastic cap # 951 bears S 74° 04' 20" E 45.15'
- These bearings and distances are State Plane.

LOCATION AND COMMENTS

From the intersection of Vey Road with Whitehouse Road go south along Whitehouse Road 2.5 miles to corner. Corner lies just south of the end of graveled road and 12' East of centerline graveled road.

SURVEYOR'S SEAL

FIRM: EDWARDS SURVEYING LLC
PO BOX 763 - HERMISTON OR 97838

PARTY CHIEF: G. EDWARDS
WITNESS: R. SMITH

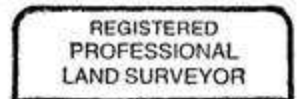

G. Dennis Edwards

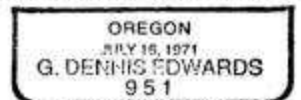

RENEWS 12/31/11