

**OREGON CORNER RESTORATION FORM**

SECTION: 6 TOWNSHIP: 2N RANGE: 29E E-1

COUNTY: UMATILLA DATE: 8/2010

**CORNER DESIGNATION**

SW 6

     CONDITION REPORT ONLY  
     NOT FOUND  
  X   RENEWED  
     UNRECORDED  
     SURVEYED IN  
  X   REFERENCED OUT

**PREVIOUS RENEWALS/SURVEYS ETC.**

Originally surveyed by Thompson under Contract #83 in 1859. He set post and made mound.  
In a 1964 survey for Cunha-Correa, Wayne Harris set a 5/8" iron rebar with stone next to it.

**MONUMENTS AND ACCESSORIES FOUND: CONDITON AND SOURCE**

Found 5/8" iron rebar and stone.

**MONUMENT DETAIL**

T2N  
R28E                  R29E  
    1 | 6  
    12 | 7

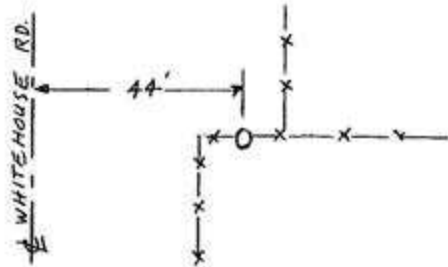

**OREGON STATE PLANE COORDINATES NORTH ZONE, NAD 83(91), Int Feet:**

734525.41  
8522003.04

**MONUMENT SET (PROCEDURES AND DESCRIPTION)**

**NEW ACCESSORIES FROM WHICH**

A 5/8" x 30" Iron Rebar with plastic cap #951 bears N 89° 25' 45" E 21.96'  
A 5/8" x 30" Iron Rebar with plastic cap #951 bears N 8° 41' 17" W 91.39'  
A 5/8" x 12" Iron Rebar with plastic cap # 951 bears S 88° 22' 26" W 54.22'  
A 5/8" x 30" Iron Rebar with plastic cap # 951 bears S 12° 46' 26" W 47.45'  
These bearings and distances are State Plane.

**LOCATION AND COMMENTS**

From the intersection of Vey Road with Whitehouse Road go south along Whitehouse Road 1 mile to corner. Corner lies 44' East of centerline graveled road.

SURVEYOR'S SEAL

FIRM: EDWARDS SURVEYING LLC  
PO BOX 763 - HERMISTON OR 97838

PARTY CHIEF: G. EDWARDS  
WITNESS: R. SMITH

