

Form 874-9—Revised May, 1918

U. S. Department of Agriculture
FOREST SERVICE

UMATILLA NATIONAL FOREST

CORNERS OF THE PUBLIC SURVEY

T. 15 R. 38 E W. 1/4 Mer.

4 Sec. Corner common to Sections

_____, _____, 18, and 19

Corner consists of a None found (not) in place

State condition Pit

Dimensions above ground _____ inches

Sketch grooves, letters, figures, or notches, on proper face or edge.

CARDINAL POSITION

DIAGONAL POSITION

--	--	--	--

N W S E

--	--	--	--

NW SW SE NE

Mound of _____ is located _____

Pits are located _____

Sketch markings of Bearing Trees (or Rocks) in proper box and fill blanks below, giving bearings from Corner to Trees and Distances in links.

<u>SECRET</u> <u>SECRET</u> <u>1/4</u> <u>S</u>	<u>SECRET</u> <u>SECRET</u> <u>1/4</u> <u>S</u>		
<u>BT</u>	<u>BT</u>		

Species W. h. W. h.

Diameter 10" 10"

Bearing _____

Distance _____

Do you believe this to be a genuine Land Office Corner? Yes

If not, why? _____

W. A. C. ...
(Signature)

10/17/39
(Date)

T. 15 R. 38 E W.M. Mer.

(Make sketch of topography near Corner)

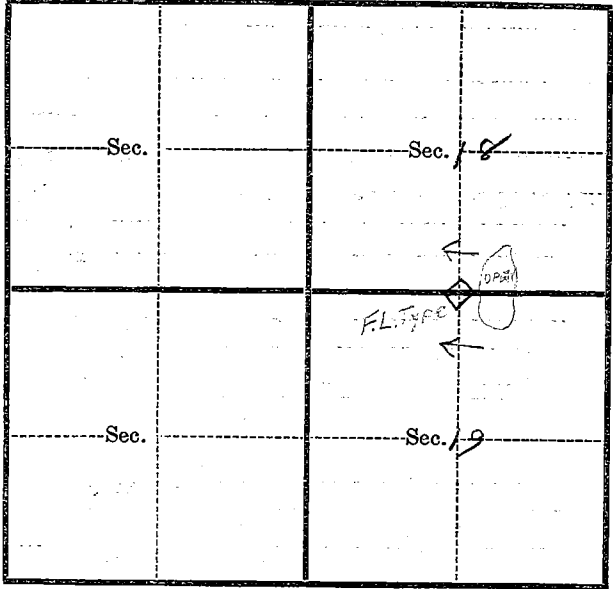

Metal Location Poster is on a W.F.
 tree 12 inches diameter, on the South
 side of Tree
 from which this Corner bears South
approx. 5 ft. chains distant.

Give any further facts which will aid in finding this
 Corner again.

Both bearing trees dead
bearing tree in sec. 19 in
down

Corner is 225' West of N.W. corner
road

Index
 File No. N-3
 T 15 R. 38E
 Merid. Willamette

CORNER RECORD (SEARCH)
 (Ref. FSM 7151.4)

Tract or
 Survey No. _____
 Cor. 1/4 18
 No. 19

R.D. LaGrande County Union
 N.F. W-W State Oregon

CORNER DIAGRAM

DESCRIBE CORNER MONUMENT FOUND

None

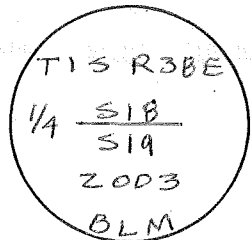

DESCRIBE BEARING TREES OR OTHER OFFICIAL ACCESSORIES FOUND

Decayed tamarack stump bears N30°E, 4.0'; w/ trunk alongside w/ visible scribing 10" decayed trunk, dead and down, w/ visible scribing. Original position could not be determined.

PHOTO IDENTIFICATION DATA

Photo No. _____
 Filed At. _____
 Object Ident. _____
 Ident. By _____
 Signature _____

DESCRIBE CORNER LOCATION RELATIVE TO NEAR-BY FEATURES, ALSO HOW TO REACH CORNER

PLANE COORDINATE POSITION DATA

State _____ Zone _____
 X _____
 Y _____
 Estab. By _____
 Agency _____

Signature _____ Title _____ Division _____ Headquarters _____ Date _____

Bryan Seibold Cad. Sur. BLM Pendleton 2003

CORNER RECORD (PERPETUATION)

MONUMENT: DESCRIBE NEW MONUMENT SET, OR WORK DONE TO PRESERVE EXISTING MONUMENT

Set stainless steel post, 28" long, 2 1/2" diam, 27" in ground, in a mound of stone, with brass cap. Deposit a white magnet at the base of post.

ACCESSORIES : DESCRIBE NEW BT'S WITNESS OBJECTS ETC. ESTABLISHED, OR WORK DONE TO PRESERVE EXISTING EVIDENCE

24" Fir bears N 18 3/4° E, 28.4' scribed 1/4 S 18 BT
19" Fir bears S 75 3/4° E, 13.5' scribed 1/4 S 19 BT

Distance measured to 2 1/2" x 1/4" Mag Nail on right side center

Work Done By B. Seibold Title Cad. Sur. Date 2003 State Registration No. BLM
or Agency

Certified Cor. Record Prepared? Yes No Filed At: _____ Date _____

REMARKS

Index File No. N-3 T. 15 R. 38E M. Will Tract or Surv. No. _____ Cor. _____

USDA-FOREST SERVICE

Index File No. N-3

CORNER RECORD (SEARCH)

(Ref. FSM 7151.4)

Tract or Survey No. _____ Cor. No. 1/4 18:19

T 15 R. 30E

R.D. La Grande County Union

Merid. Will.

N.F. W-W State Oregon

CORNER DIAGRAM

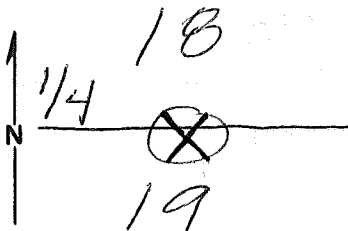

DESCRIBE CORNER MONUMENT FOUND

None

DESCRIBE BEARING TREES OR OTHER OFFICIAL ACCESSORIES FOUND

Fcl. N30°E BT dead on ground with no bark and all scribbles visible. The stump hole is approximately 5 ft. SE of down BT.

PHOTO IDENTIFICATION DATA

Photo No. _____
Filed At. _____
Object Ident. _____
Ident. By _____
Signature

DESCRIBE CORNER LOCATION RELATIVE TO NEAR-BY FEATURES, ALSO HOW TO REACH CORNER

Corner is located 800 ft. west of Road #3120. Put K-tag on 30" Doug. Fir on East side of Road #3120 starting this.

PLANE COORDINATE POSITION DATA

State _____ Zone _____
X _____
Y _____
Estab. By _____
Agency

Signature Heather Andrew Miller Title Tech. Division L.L.L. Headquarters GREZ Date 9-92

CORNER RECORD (PERPETUATION)

MONUMENT: DESCRIBE NEW MONUMENT SET, OR WORK DONE TO PRESERVE EXISTING MONUMENT

None

ACCESSORIES : DESCRIBE NEW BT'S WITNESS OBJECTS ETC. ESTABLISHED, OR WORK DONE TO PRESERVE EXISTING EVIDENCE

Painted scribing red and placed B.T. tag and Land Survey Monument Sign on down B.T.

Earl Strang

Work Done By H. Hendrix Miller Title Survey Tech Date 9-92 State Registration No. or Agency _____

Certified Cor. Record Prepared ? Yes No Filed At _____ Date _____

REMARKS

Fd. Forest Service k-tag on 19" white Fir next to down B.T. It was posted in 10-18-39 by M.G.J. Placed Land Survey Monument Sign on this tree.

Index File No. N-3 T. 15 R. 38E M. Will Tract or Surv. No. _____ Cor. 1/4 18:19

U. S. Department of Agriculture
FOREST SERVICE

N-3

UMRILLA NATIONAL FOREST
CORNERS OF THE PUBLIC SURVEY

T. 15 R. 38 E W. 19 Mer.

S.E.C. Corner common to Sections

_____, _____, 18, and 19

Corner consists of a stone (not) in place

State condition poor

Dimensions above ground _____ inches

Sketch grooves, letters, figures, or notches, on proper face or edge.

CARDINAL POSITION

DIAGONAL POSITION

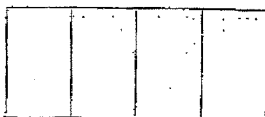

Mound of _____ is located _____

Pits are located _____

Sketch markings of Bearing Trees (or Rocks) in proper box and fill blanks below, giving bearings from Corner to Trees and Distances in Feet. Sec. 18

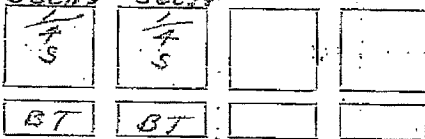

Species W.L. W.L.

Diameter 10" 10"

Bearing _____

Distance _____

Do you believe this to be a genuine Land Office Corner? Yes

If not, why? _____

Wack Jackson

(Signature)

10/17/39

(Date)

Forest Guard

(Title)

T. 15 R. 38 E. W. 14 Mer.

(Make sketch of topography near Corner)

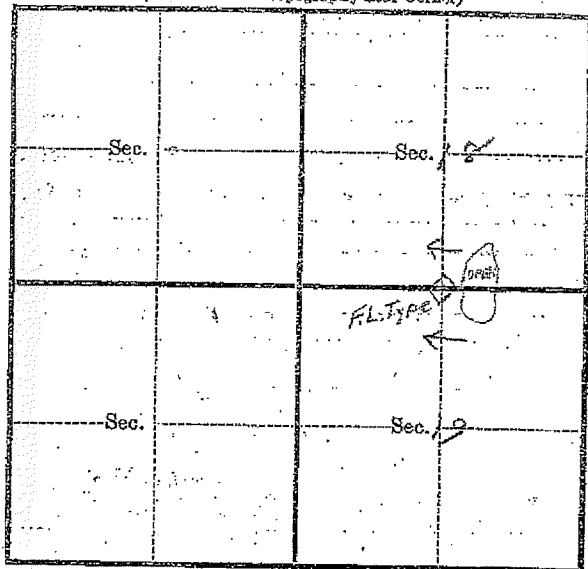

Metal Location Poster is on a W.F.
 tree 12 inches diameter, on the South
 side of Tree
 from which this Corner bears S. 56th
approx. 5th chains distant.

Give any further facts which will aid in finding this
 Corner again.

Both bearing trees dead
Bearing trees in sec. 19 are
downed

Corner 225' West of Mt. Hardy
road