

Index  
File No. L-1

**CORNER RECORD (SEARCH)**  
(Ref. FSM 7151.4)

Tract or  
Survey No. \_\_\_\_\_

Cor.  
No. 13 | 18

T 15 R. 38E

R.D. LaGrande County Union

Merid. \_\_\_\_\_

N.F. W-W State Oregon

**CORNER DIAGRAM**

**DESCRIBE CORNER MONUMENT FOUND**

*Searched for nothing found*

**DESCRIBE BEARING TREES OR OTHER OFFICIAL ACCESSORIES FOUND**

**DESCRIBE CORNER LOCATION RELATIVE TO NEAR-BY FEATURES, ALSO HOW TO REACH CORNER**

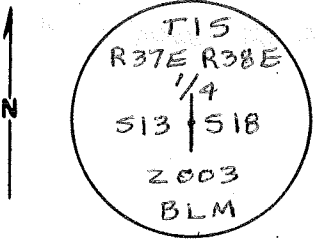

**PHOTO IDENTIFICATION DATA**

Photo No. \_\_\_\_\_  
Filed At. \_\_\_\_\_  
Object Ident. \_\_\_\_\_  
Ident. By \_\_\_\_\_  
*Signature*

**PLANE COORDINATE POSITION DATA**

State \_\_\_\_\_ Zone \_\_\_\_\_  
X \_\_\_\_\_  
Y \_\_\_\_\_  
Estab. By \_\_\_\_\_  
*Agency*

Signature	Title	Division	Headquarters	Date	FS-7100-52 (3/68)
<i>Bryan Seibold</i>	<i>Cad. Surv.</i>	<i>BLM</i>	<i>Pendleton</i>	<i>2003</i>	

## CORNER RECORD (PERPETUATION)

MONUMENT: DESCRIBE NEW MONUMENT SET, OR WORK DONE TO PRESERVE EXISTING MONUMENT

Set stainless steel post 28" long 2 1/2" diam 26" in the ground with brass cap and white magnet at base of post.

ACCESSORIES : DESCRIBE NEW BT'S WITNESS OBJECTS ETC. ESTABLISHED, OR WORK DONE TO PRESERVE EXISTING EVIDENCE 9

30" Tamarack bears NB9°E, 9.3' scribed 1/4 S18 BT

22" Tamarack bears S18 1/2°W, 23.3' scribed 1/4 S13 BT

Distance measured to 2 1/2" x 1/4" Mag Nail in right side center

Work Done By B Seibold Title Cad. Surv. Date 2003 State Registration No. BLM  
or Agency

Certified Cor. Record Prepared? Yes  No  Filed At:

Date

11

REMARKS

Index File No.

T.

R.

M.

Tract or Surv. No.

Cor.

12

13

L-1

15

386

Will.