

Index  
File No. J-1  
T 15 R. 38E  
Merid. Willamette

**CORNER RECORD (SEARCH)**  
(Ref. FSM 7151.4)

Tract or  
Survey No. \_\_\_\_\_  
Cor. 12 | 7  
No. 13 | 18

R.D. LaGrande County Union  
N.F. W-W State Oregon

**CORNER DIAGRAM**

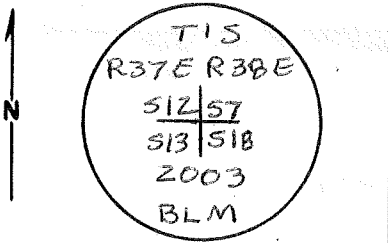

**DESCRIBE CORNER MONUMENT FOUND**

searched for nothing found

**DESCRIBE BEARING TREES OR OTHER OFFICIAL ACCESSORIES FOUND**

**PHOTO IDENTIFICATION DATA**

Photo No. \_\_\_\_\_  
Filed At. \_\_\_\_\_  
Object Ident. \_\_\_\_\_  
Ident. By \_\_\_\_\_  
*Signature*

**DESCRIBE CORNER LOCATION RELATIVE TO NEAR-BY FEATURES, ALSO HOW TO REACH CORNER**

Corner located S30°W, 100' from ravine  
draining N50°W

**PLANE COORDINATE POSITION DATA**

State \_\_\_\_\_ Zone \_\_\_\_\_  
X \_\_\_\_\_  
Y \_\_\_\_\_  
Estab. By \_\_\_\_\_  
*Agency*

Signature Bryan Seibold Title Cad. Sur. Division BLM Headquarters Pendleton Date 2003

## CORNER RECORD (PERPETUATION)

MONUMENT: DESCRIBE NEW MONUMENT SET, OR WORK DONE TO PRESERVE EXISTING MONUMENT

Set stainless steel post 28" long, 2 1/2" diam, 24" in the ground in stone mound with brass cap. Deposit white magnet at base of post.

ACCESSORIES : DESCRIBE NEW BT'S WITNESS OBJECTS ETC. ESTABLISHED, OR WORK DONE TO PRESERVE EXISTING EVIDENCE 9

12" Spruce bears N56 1/2° E, 26.9' scribed T15 R38E S7 BT

25" Spruce bears S27° E, 61.2' scribed T15 R38E S18 BT

14" Tamarack bears S73° W, 55.1' scribed T15 R37E S13 BT

18" Tamarack bears N45 1/4° W, 62.7' scribed T15 R37E S12 BT

Distance measured to 2 1/2" x 1/4" Mag Nail in right side center 10

Work Done By B. Seibold Title Cad. Surv. Date 2003 State Registration No. BLM  
or Agency

Certified Cor. Record Prepared? Yes  No  Filed At:

Date

11

## REMARKS

Index File No.

T.

R.

M.

Tract or Surv. No.

Cor.

1213

J-1

15 - 38E

Will.