

**CERTIFIED RECORD OF LAND CORNER MONUMENTATION**

**History of original corner establishment:**

Corner originally established by Henry Meldrum under GLO contract number 450, dated June 11, 1882. Surveyor General record states:

Set basalt stone 16x12x10 ins 11 ins in ground for ¼ sec cor marked ¼ on N face from which;

A fir 5 in diam bears N29°W 159 lks dist marked ¼S BT  
 A fir 4 in diam bears S52°W 189 lks dist marked ¼S BT

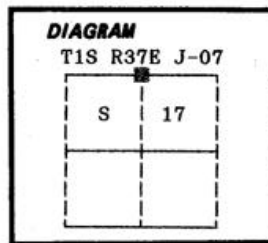

No record of subsequent monumentation found in Umatilla County survey records.

**Description of corner evidence found:**

Found no evidence of the original corner monument.  
 NOTE: A mound of stone was found S17°E, 36 feet from the found original Northwest bearing tree described below.

**ORIGINAL BEARING TREES**

Found a stump hole S52°W, 189 lks with rotted Fir remains  
 No marks visible.

Found a 28 inch diameter Douglas Fir N29°W, 159 lks live and vigorous with blaze evident. The tree had been opened on at least 2 previous occasions. Due to the discrepancy between the bearing tree and the mound of stone, I opened the tree, finding the ¼S scribing.

**Description of monument and accessories I established to perpetuate the**

**original location of this corner:** At record bearing and distance from the found original bearing tree, I set a 2½" x 30" aluminum pipe with aluminum cap marked as shown, 10 inches in the ground, from which:

**New Bearing Trees:**

A 13 inch diameter Ponderosa Pine bears N23°E, 58.62 feet marked ¼ S8 BT  
 A 15 inch diameter Ponderosa Pine bears S35°E, 105.80 feet marked ¼ S17 BT

Painted a 6 inch red band around all BTs and attached bearing tree and land survey monument signs.

Set a steel fencepost approximately 5 feet North with land survey monument sign attached.

Raised a mound of stone around monument, 4 ft. base to top of cap.

I hereby certify that the above corner point was perpetuated as hereon described on August 18, 1989.

Witness: Jeff Petersen

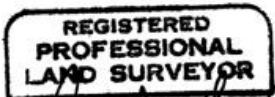
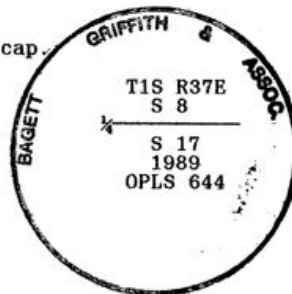

*Handwritten signature of Duane I. Griffith*  
 OREGON  
 JULY 12, 1984  
**DUANE I. GRIFFITH**  
 644

I used a steel tape and magnetic compass in the establishment of new accessories. I used 17° East magnetic declination and the distances are to a 50d spike driven in the right side of the root crown. I attached a brass washer marked OPLS 644 to the BT blaze.

Office of the Survey Dept County of Umatilla  
 State of OR I hereby certify that the within instrument was filed in this office  
 for record on the 27<sup>th</sup> day of October 1989  
David H. Raumborn by Kathleen K. Knudsen  
 (COUNTY OFFICIAL) (DEPUTY)

Form R6-7100-57 (9/71)

\*GPO-591-971, 1988

RECORDED BY  
 Umatilla County Surveyor  
 Date 10-89  
 Book KA  
 No. 89-106-L