

Form 874-9—Revised May, 1918

U. S. Department of Agriculture
FOREST SERVICE

Washita NATIONAL FOREST

CORNERS OF THE PUBLIC SURVEY

T. 18 R. 36E W Mer.

Section Corner common to Sections
18, 29, 32, and 33

Corner consists of a Jack + Stake (not) in place

State condition Stake replaced

Dimensions above ground _____ inches.

Sketch grooves, letters, figures, or notches, on proper face or edge.

N	W	S	E

NW	SW	SE	NE

Mound of _____ is located _____

Pits are located _____

Sketch markings of Bearing Trees (or Rocks) in proper box and fill blanks below, giving bearings from Corner to Trees and Distances in Links.

T 15 R 36E S 29			T 15 R 36E S 29
BT			BT

Species Junglucarp 6-8' unspiral
 Diameter 30" 11"
 Bearing N 59 W N 45 E
 Distance 14' 41'

Do you believe this to be a genuine Land Office Corner? yes

If not, why? _____

Walter T. Morrison
(Signature)

11-9-33
(Date)

Forest Ranger
(Title)

T. 15 R. 34E W Mer.

(Make sketch of topography near Corner)

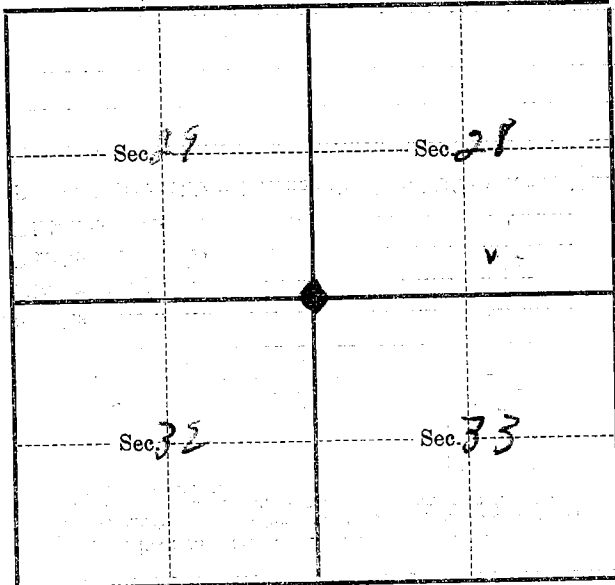

Metal Location Poster is on a Yamacah B.T.
 tree 20 inches diameter, on the E
 side of tree
 from which this Corner bears S59E
14 ft chains distant.

Give any further facts which will aid in finding this
 Corner again

N of Hunt cabin at extreme
edge of clearing

USDA-FOREST SERVICE

Index File No. V-9

CORNER RECORD (SEARCH)

(Ref. FSM 7151.4)

Tract or Survey No. _____ Cor. No. _____

T 15 R. 36E

R.D. _____ County UNION

Merid. WILLAMETTE

N.F. UMATILLA State OREGON

CORNER DIAGRAM

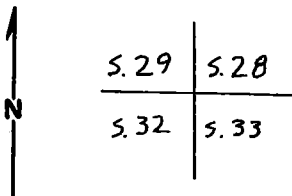

DESCRIBE CORNER MONUMENT FOUND

FOUND A 2 1/2" DIAM. BRASS CAP IN A ROCK MOUND AND STAMPED PER SKETCH.

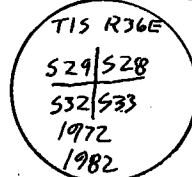

DESCRIBE BEARING TREES OR OTHER OFFICIAL ACCESSORIES FOUND

- ① A 30" D.B.H. TAMARACK N. 61° W., 14.6' SCRIBED T15 R36E 529, 2 BT TAGS.
- ② A 16" D.B.H. LODGEPOLE PINE, S. 47° W., 37.7' WITH SCRIBING (PITCHED OVER) BRASS WASHER PLS 848 & BT TAG.
- ③ A 8" D.B.H. LODGEPOLE PINE SNA6, S. 28° E, (S. 35° E), 38.3' SCRIBING (PITCHED OVER) BRASS WASHER PLS 848 AND BT TAG.
- ④ A 10" D.B.H. LODGEPOLE PINE SNA6, (N. 40° E.) N. 43° E., (40.3') 40.8' SCRIBING (PITCHED OVER) BRASS WASHER PLS 848
- ⑤ WINDFALL WITH SCRIBES T1528 BT VISIBLE N. 35° E., 57 LINKS

PHOTO IDENTIFICATION DATA

Photo No. _____
Filed At. _____
Object Ident. _____
Ident. By _____
Signature _____

PLANE COORDINATE POSITION DATA

State _____ Zone _____
X _____
Y _____
Estab. By _____
Agency _____

DESCRIBE CORNER LOCATION RELATIVE TO NEAR-BY FEATURES, ALSO HOW TO REACH CORNER

AT MT. EMILY TURNOFF, GO NORTH ON F.R. 31, 2.5 MILES TO FIRST ROAD PAST 3102 ROAD (NEW ROAD) TURN LT., GO 0.2 MILES, SEE CORNER 150' NORTH OF 1 ROAD IN NEW CUTTING, NEAR DRAINAGE.

Signature Clayton J. M... D.

Title LAND SURVEYOR Division _____ Headquarters _____ Date SEPT. 14, 1982 7100-52-(3/68)

CORNER RECORD (PERPETUATION)

MONUMENT: DESCRIBE NEW MONUMENT SET, OR WORK DONE TO PRESERVE EXISTING MONUMENT

ACCESSORIES : DESCRIBE NEW BT'S WITNESS OBJECTS ETC. ESTABLISHED, OR WORK DONE TO PRESERVE EXISTING EVIDENCE

① A 8" D.B.H. LODGEPOLE PINE, S. 43° E., 64.3', SCRIBED TIS R36E S33 B.T. BRASS WASHER
RPLS 1910 BETWEEN B & T,
STEEL FENCE POST 4.5' WEST

Work Done By C.J. MARTIN Title LAND SURVEYOR Date 9-14-82 State Registration No. or Agency _____

Certified Cor. Record Prepared? Yes No Filed At: _____ Date _____

REMARKS

Index File No. T. 15 R. 36E M. WILLAHETTE Tract or Surv. No.

Cor. 29 FEB 13
U.S. G.P.O. 1977-728-876/586

Index File No. V-9
 T 1 S R. 36 E
 Merid. Willamette

CORNER RECORD (SEARCH)
 (Ref. FSM 7151.4)

Tract or Survey No. V 9 Cor. No. Sec 72

R.D. pendleton County Umatilla
 N.F. Umatilla State Oregon

CORNER DIAGRAM

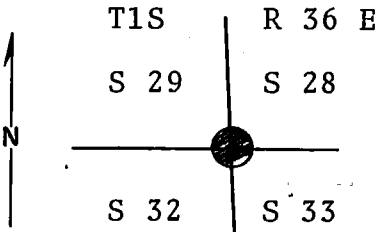

DESCRIBE CORNER MONUMENT FOUND

Brass cap set summer 1972. See reverse side.

DESCRIBE BEARING TREES OR OTHER OFFICIAL ACCESSORIES FOUND

Found 13x10x8" basalt stone with 4 faint notches. Stone is laying on surface approx. 4' South from corner position as determined by Bearing Trees.
 Found live healthy 30" tamarack marked T1S R36E S29 BT visible bearing N60°W 13.2 ft. dist. from corner.
 Found down and dead lodgepole pine 14" dia. marked T1S R36E S28 BT visible, bearing N35°E 37.6' dist.

DESCRIBE CORNER LOCATION RELATIVE TO NEAR-BY FEATURES, ALSO HOW TO REACH CORNER from the corner position.

Found remains of pine with faint scribing visible, indentation where tree apparently stood bears S40°E 28' from corner position.
 Found line blazes running South.

PHOTO IDENTIFICATION DATA

Photo No. _____
 Filed At. _____
 Object Ident. _____
 Ident. By _____

Signature _____

PLANE COORDINATE POSITION DATA

State _____ Zone _____
 X _____
 Y _____
 Estab. By _____
 Agency _____

Signature

Title

Division

Headquarters

Date

7100-52 (3/68)



CORNER RECORD (PERPETUATION)

MONUMENT: DESCRIBE NEW MONUMENT SET, OR WORK DONE TO PRESERVE EXISTING MONUMENT

Set 30x2½" iron pipe with 3" brass cap marked as shown, 26" in the ground and placed the original stone South & alongside pipe, for the corner to sections 28, 29, 32 & 33 as determined from the above evidence, & raised a mound of stone around the pipe. From which new BTs:

9

ACCESSORIES : DESCRIBE NEW BT's WITNESS OBJECTS ETC. ESTABLISHED, OR WORK DONE TO PRESERVE EXISTING EVIDENCE

A lodgepole pine 12" dia. bears N40°E 40.3' dist. marked T1S R36E S28 BT.
 A lodgepole pine 9" dia. bears S35°E 38.3' dist. marked T1S R36E S33 BT.
 A lodgepole pine 8" dia. bears S47°W 37.7' dist. marked T1S R36E S32 BT.
 Distances taken to a brass washer in the blazes of each tree.
 Set a steel fence post approx. 5' West from pipe with Forest Boundary sign attached.

Used a steel tape & magnetic compass with declination = 20° East. 10

Work Done By D. M. Ferguson Title Land Surveyor Date 7/12/69 State Registration No. 848
 or Agency

Certified Cor. Record Prepared ? Yes No Filed At: Umatilla Co. Courthouse Date 11/16/72 11

REMARKS

12

Index File No. V-9 T. R. M. Tract or Surv. No. Cor. 13