

Index File No. R-02

CORNER RECORD (SEARCH)

(Ref. Form 7151.4)

Tract or Survey No. _____ Cor. No. _____

T 1 S R. 36 E R.D. WALLA WALLA County UMATILLA

Merid. W.M N.F. UMATILLA State OREGON

CORNER DIAGRAM

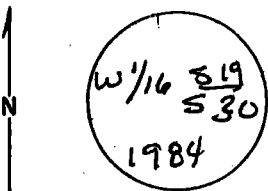

DESCRIBE CORNER MONUMENT FOUND

END 3 1/4" BLM BRASS CAP RISING 4" ABOVE GROUND

DESCRIBE BEARING TREES OR OTHER OFFICIAL ACCESSORIES FOUND

8" SPRUCE, BLAZED & SCRIBED W 1/16 S 19 BT, BEARS N 14 1/2° W, 36 LKS, 23.8 FT.
8" PINE BLAZED & SCRIBED W 1/16 S 30 BT BEARS S 29 3/4° E, 7 1/2 LKS, 5.0 FT.

PHOTO IDENTIFICATION DATA

Photo No. _____
Filed At. _____
Object Ident. _____
Ident. By _____
Signature

PLANE COORDINATE POSITION DATA

State _____ Zone _____
X _____
Y _____
Estab. By _____
Agency

DESCRIBE CORNER LOCATION RELATIVE TO NEAR-BY FEATURES, ALSO HOW TO REACH CORNER

FROM 3100 NORTH ON 3101 0.3 MILE ON UNMARKED ROAD 0.6 MILE, RT ON UNMARKED ROAD TO RIDGE TOP FOLLOW RIDGETOP ROAD NW 1/4 1 MILE SW COR OF SEC 19 IS VISIBLE 150' RT OF ROAD - EAST 1/4 MILE ALONG SOUTH LINE OF S 19 TO CORNER - GENTLE NE SLOPE TIMBERED.

Signature

[Handwritten Signature]

Title

LS 1848

Division

Headquarters

Date

2-2-85

CORNER RECORD (PERPETUATION)

MONUMENT : DESCRIBE NEW MONUMENT SET, OR WORK DONE TO PRESERVE EXISTING MONUMENT

NONE

ACCESSORIES : DESCRIBE NEW BT'S WITNESS OBJECTS ETC. ESTABLISHED, OR WORK DONE TO PRESERVE EXISTING EVIDENCE

SET STEEL FENCE POST
ATTACHED SIGNS TO POST & BT'S

Work Done By BA SUTTON Title SURVEYOR Date 7-2-85 State Registration No. LS 1848
or Agency

Certified Cor. Record Prepared ? Yes No Filed At:

Date

REMARKS

Index File No. R-02 T. 15 R. 36E W.M. W 1/16 Tract or Surv. No. Cor. 519/20