

Index
File No. N-07

CORNER RECORD (SEARCH)
(Ref. FSM 7151.4)

Tract or
Survey No. _____
Cor.
No. _____

T IS R. 36E
Merid. WM

R.D. WALLA WALLA County UMATILLA
N.F. UMATILLA State OREGON

CORNER DIAGRAM

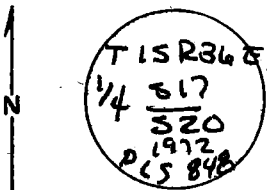

DESCRIBE CORNER MONUMENT FOUND

FND 3" BRASS CAP RISING 6" ABOVE
GROUND

DESCRIBE BEARING TREES OR OTHER OFFICIAL ACCESSORIES FOUND

19" P.P. BEARS N 50° W - 63.8 FT
10" PINE, DEAD & DOWN, BEARS N 15° E,
62 LKS
40.9 FT.

PHOTO IDENTIFICATION DATA

Photo No. _____
Filed At. _____
Object Ident. _____
Ident. By _____
Signature

DESCRIBE CORNER LOCATION RELATIVE TO NEAR-BY FEATURES, ALSO HOW TO REACH CORNER

ON TOP RIDGE
FROM LOCATION POSTER ON 12" FIR ON
ROAD 3102 - 020 WALK UP RIDGE TO
WEST

PLANE COORDINATE POSITION DATA

State _____ Zone _____
X _____
Y _____
Estab. By _____
Agency

Signature
D Scott

Title
LS 1844

Division

Headquarters

Date
7-12-85

FS-7100-52 (3/68)

CORNER RECORD (PERPETUATION)

MONUMENT: DESCRIBE NEW MONUMENT SET, OR WORK DONE TO PRESERVE EXISTING MONUMENT

NONE

ACCESSORIES : DESCRIBE NEW BT'S WITNESS OBJECTS ETC. ESTABLISHED, OR WORK DONE TO PRESERVE EXISTING EVIDENCE

9

SET STEEL FENCE POST

ATTACHED SIGNS TO POST & BTS

Work Done By: D.E. SCOTT Title SURVEYOR Date 7-12-85 State Registration No. LS1844
or Agency

10

Certified Cor. Record Prepared? Yes No Filed At:

Date

11

REMARKS

Index File No.

T.

R.

W.M.

Tract or Surv. No.

12

N-07

15

36E

Cor. 44 17/20
13

Index
File No. N-7
T 1 S R. 36 E
Merid. Willamette

CORNER RECORD (SEARCH)
(Ref. FSM 7151.4)

Tract or
Survey No. N 7
Cor. No. 1/4 ~~46~~

R.D. Pendleton County Umatilla
N.F. Umatilla State Oregon

CORNER DIAGRAM

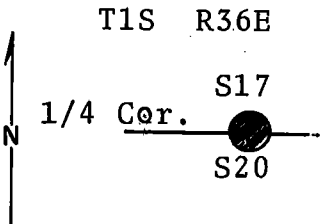

DESCRIBE CORNER MONUMENT FOUND

Set brass cap summer 1972. See reverse side.

DESCRIBE BEARING TREES OR OTHER OFFICIAL ACCESSORIES FOUND

Found 8" pine dead and down with scribing visible.
Bearing N15°E 41 ft. from 16x12x4" stone with dhipped
face. Stone is tipped over on steep ground.

PHOTO IDENTIFICATION DATA

Photo No. _____
Filed At. _____
Object Ident. _____
Ident. By _____
Signature

DESCRIBE CORNER LOCATION RELATIVE TO NEAR-BY FEATURES, ALSO HOW TO REACH CORNER

Established corner positon at stone.

PLANE COORDINATE POSITION DATA

State _____ Zone _____
X _____
Y _____
Estab. By _____
Agency

Corner laying on open E-W ridge sloping East.



Signature

Title

Division

Headquarters

Date

7100-52 (3/68)

CORNER RECORD (PERPETUATION)

MONUMENT : DESCRIBE NEW MONUMENT SET, OR WORK DONE TO PRESERVE EXISTING MONUMENT

Set 2½x30" iron pipe, with brass cap marked as shown, 25" in the ground and placed 16x12x4" stone South and alongside pipe for the 1/4 corner to sections 17 and 20. Raised a mound of stone around the pipe, from which a new BT:

9

ACCESSORIES : DESCRIBE NEW BT'S WITNESS OBJECTS ETC. ESTABLISHED, OR WORK DONE TO PRESERVE EXISTING EVIDENCE

A 24" pine bears N50°W 63.8 ft. dist. marked T1S R36E 1/4 S17 BT.

Distance taken to a brass washer in the blaze of the BT.

Set a steel fence post approx. 5 ft. West of corner with "Attention" sign attached.

Corner laying on open E-W ridge sloping East.

Used steel tape and magnetic compass with declination = 20°E.

10

Work Done By D. M. Ferguson Title Land Surveyor Date 7/12/68 State Registration No. 848
or Agency

Certified Cor. Record Prepared ? Yes No Filed At: Umatilla Co. Courthouse Date 11/16/72 11

REMARKS

Index File No.

T.

R.

M.

Tract or Surv. No.

Cor.,

12

13