

USDA-FOREST SERVICE

Index File No. J-21
 T 1S R. 36E
 Merid. Willamette

CORNER RECORD (SEARCH)

(Ref. FSM 7151.4)

Tract or Survey No. _____ Cor. No. _____
 R.D. Walla Walla County Umatilla
 N.F. Umatilla State Oregon

CORNER DIAGRAM



T1S R36E
 S11 | S12
 S14 | S13
 1994
 PLS 1106

DESCRIBE CORNER MONUMENT FOUND

Found a small mound of stone on steep hillside with a record dimension stone lying loose down hill from the mound.

DESCRIBE BEARING TREES OR OTHER OFFICIAL ACCESSORIES FOUND

A 30" ponderosa pine, healthy, with mostly healed blaze, record S20°E-250 lks, found to be S29½°E-164.6 feet.

PHOTO IDENTIFICATION DATA

Photo No. _____
 Filed At. _____
 Object Ident. _____
 Ident. By _____
Signature

DESCRIBE CORNER LOCATION RELATIVE TO NEAR-BY FEATURES, ALSO HOW TO REACH CORNER

Corner is on a very steep south slope midway into canyon.

PLANE COORDINATE POSITION DATA

State _____ Zone _____
 X _____
 Y _____
 Estab. By _____
Agency

Signature
Wally R. W...

Title
 PLS

Division

Headquarters
 PENLETON

Date
 9/28/94

FS-7100-52 (3/88)

6

7

8

2

3

4

5

CORNER RECORD (PERPETUATION)

MONUMENT: DESCRIBE NEW MONUMENT SET, OR WORK DONE TO PRESERVE EXISTING MONUMENT

Set a 2½" aluminum cap on a 2½" x 30" aluminum pipe, 20" in the ground, with mound of stone to cap. Placed record stone alongside, some chisel marks visible. Cap marked as shown in diagram. Set a steel fence post with 54-2 and 54-9 signs, 3.3 feet West of monument.

ACCESSORIES : DESCRIBE NEW BT'S WITNESS OBJECTS ETC. ESTABLISHED, OR WORK DONE TO PRESERVE EXISTING EVIDENCE

New Accessories: A 5/8" x 30" iron pin with yellow plastic cap bears N44°E-20.2 feet. A 5/8" x 30" iron pin with yellow plastic cap bears S45°W-17.7 feet. A 5/8" x 30" iron pin with yellow plastic cap N89°W-19.2 feet. Attached 54-3 sign to iron pins. Set steel fence posts near each iron pin with 54-9 signs attached.

Work Done By WR Wells Title PLS Date _____ State Registration No. PLS 1106
or Agency _____
Certified Cor. Record Prepared? Yes No _____ Filed At: UMATILLA COUNTY SURVEYOR'S OFFICE Date 12/94

REMARKS

This corner was monumented as part of a USFS contract.

Index File No. T. R. M. Tract or Surv. No. Cor. 12
13

J21 1S 36E Willamette

USDA-FOREST SERVICE

Index File No. J-21

CORNER RECORD (SEARCH)
(Ref. FSM 7151.4)

Tract or Survey No. _____ Cor. No. J-21

T 1S R. 36E R.D. Pendleton County Umatilla

Merid. Willamette N.F. Umatilla State Oregon

CORNER DIAGRAM

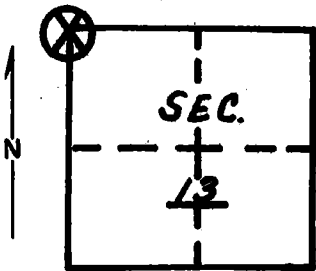

DESCRIBE CORNER MONUMENT FOUND

None

DESCRIBE BEARING TREES OR OTHER OFFICIAL ACCESSORIES FOUND

28" P. Pine blazed on Northwest face, scribed: 36 13.
There is a location poster above blaze dated: 10/18/40 G.I.
Poster also dated 8/6/64 USGS. Several loose stones of size described in G.L.O. notes but no visible marks were on them. No trace of mound of stones.

PHOTO IDENTIFICATION DATA

Photo No. _____
Filed At. _____
Object Ident. _____
Ident. By _____
Signature

DESCRIBE CORNER LOCATION RELATIVE TO NEAR-BY FEATURES, ALSO HOW TO REACH CORNER

PLANE COORDINATE POSITION DATA

State _____ Zone _____
X _____
Y _____
Estab. By _____
Agency

Signature

Bill Moore

Title

Eng. Tech.

Division

Headquarters

Date

6/77

7100-52-(3/68)

CORNER RECORD (PERPETUATION)

GPO 902-679

MONUMENT : DESCRIBE NEW MONUMENT SET, OR WORK DONE TO PRESERVE EXISTING MONUMENT

9

ACCESSORIES : DESCRIBE NEW BT'S WITNESS OBJECTS ETC. ESTABLISHED, OR WORK DONE TO PRESERVE EXISTING EVIDENCE

I placed a blank F.S. bearing tree poster above the blaze facing section corner locations.

10

Work Done By _____ Title _____ Date _____ State Registration No. or Agency _____

Certified Cor. Record Prepared ? Yes No Filed At: _____ Date _____

11

REMARKS

12

Index File No. T. R. M. Tract or Surv. No. Cor.

13