

Index
File No. F-03

CORNER RECORD (SEARCH)
(Ref. FSM 7151.4)

Tract or
Survey No. _____
Cor.
No. _____

T LS R. 36E

R.D. WALLA WALLA County UMATILLA

Merid. W.M

N.F. UMATILLA State OREGON

CORNER DIAGRAM

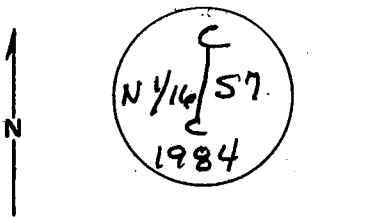

DESCRIBE CORNER MONUMENT FOUND

3 1/4" BLM BRASS CAP ON 2 1/2" IP RISING 4"

DESCRIBE BEARING TREES OR OTHER OFFICIAL ACCESSORIES FOUND

10" WHITE FIR BLAZED & SCRIBED CN 1/16 S7 BT
BEARS N 153/4° W - 21 LKS - 13.2 FT

8" WHITE FIR BLAZED & SCRIBED CN 1/16 S7 BT
BEARS N 55° E - 9 1/2 LKS - 6.3 FT

DESCRIBE CORNER LOCATION RELATIVE TO NEAR-BY FEATURES, ALSO HOW TO REACH CORNER

STEEP NORTHEILY SLOPE 400' ABOVE ALLEN CREEK
3/4 MILES WEST ALONG POSTED NORTH 1/16 LINE
THROUGH N.W 1/4 S8 & NE 1/4 S7 FROM
RAILROAD

PHOTO IDENTIFICATION DATA

Photo. No. _____

Filed At. _____

Object Ident. _____

Ident. By _____

Signature

PLANE COORDINATE POSITION DATA

State _____ Zone _____

X _____

Y _____

Estab. By _____

Agency

Signature

Stanton

Title

LS 1848

Division

Headquarters

Date

6-25-85

FS-7100-52 (3/68)

CORNER RECORD (PERPETUATION)

MONUMENT: DESCRIBE NEW MONUMENT SET, OR WORK DONE TO PRESERVE EXISTING MONUMENT

NONE

ACCESSORIES : DESCRIBE NEW BT'S WITNESS OBJECTS ETC. ESTABLISHED, OR WORK DONE TO PRESERVE EXISTING EVIDENCE

SET STEEL FENCE POST 3' SOUTH
ATTACHED SIGNS TO POST & BT'S PAINTED RED BANDS

Work Done By B. SUTTON Title SURVEYING Date 6-85 State Registration No. LS 1848
or Agency

Certified Cor. Record Prepared? Yes No Filed At: _____ Date _____

REMARKS

Index File No. F-03 T. 15 R. 36E W.M. _____ Tract or Surv. No. _____
Cor. 1/16 57