

CORNER RECORD (SEARCH)

(Ref. FSM 7151.4)

Tract or Survey No. _____

Cor. No. _____

Index File No. B-8

T 15 R. 36E

R.D. _____ County UMATILLA

Merid. Will.

N.F. UMATILLA State OR

CORNER DIAGRAM

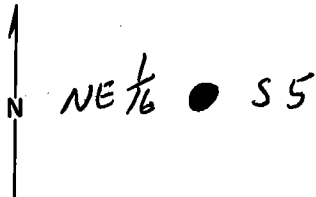

DESCRIBE CORNER MONUMENT FOUND

2 1/2" GALV. IRON PIPE WITH BLM BR. CAP NE 1/6 S5
MKD. → 1984

DESCRIBE BEARING TREES OR OTHER OFFICIAL ACCESSORIES FOUND

6" FIR, WITH SCRIBES "NE 1/6 S5 BT" BEARS N45°W,
21 1/2 LKS.

11" FIR, WITH SCRIBES "NE 1/6 S5 BT" BEARS N50 3/4°E,
75 1/2 LKS.

DESCRIBE CORNER LOCATION RELATIVE TO NEAR-BY FEATURES, ALSO HOW TO REACH CORNER

LIES NEAR BOTTOM OF SHALLOW DRAW, COURSE W.
IN SPARSE TIMBER + BRUSH.

PHOTO IDENTIFICATION DATA

Photo No. _____

Filed At. _____

Object Ident. _____

Ident. By _____

Signature

7

PLANE COORDINATE POSITION DATA

State _____ Zone _____

X _____

Y _____

Estab. By _____

Agency

8

Signature Victor Michael LS

Title

Division

Headquarters

Date

4-22-86

FS-7100-52 (3/68)

4

CORNER RECORD (PERPETUATION)

MONUMENT : DESCRIBE NEW MONUMENT SET, OR WORK DONE TO PRESERVE EXISTING MONUMENT

ACCESSORIES : DESCRIBE NEW BT'S WITNESS OBJECTS ETC. ESTABLISHED, OR WORK DONE TO PRESERVE EXISTING EVIDENCE

ATTACHED SIGN 54-4 TO BACK OF BT'S
PAINTED RED BAND AROUND BT'S
SET STEEL POST ABOUT 4' E. OF CORNER, WITH SIGN 54-9

Work Done By. V. McLIND Title LS Date 6-3-86 State Registration No. 934
or Agency
Certified Cor. Record Prepared ? Yes No Filed At: _____ Date _____

REMARKS

Index File No. B-8 T. 15 R. 36E M. WILL. Tract or Surv. No. _____ Cor. _____