

Index  
File No. R-25

**CORNER RECORD (SEARCH)**

(Ref. FSM 7151.4)

Tract or Survey No. \_\_\_\_\_  
Cor. No. R-25

T 1 S R. 35 E R.D. Pendleton County Umatilla

Merid. Willamette N.F. Umatilla State Oregon

**CORNER DIAGRAM**

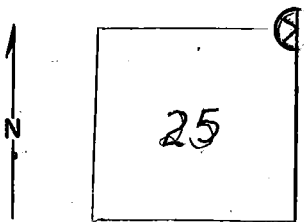

**DESCRIBE CORNER MONUMENT FOUND**

None found.

*BLM BRASS CAP*

**DESCRIBE BEARING TREES OR OTHER OFFICIAL ACCESSORIES FOUND**

16" BT stump with blazed face S. 55° E. Scribing: "BT" visible.  
Stump with chopping resembling that of a scribed blaze bears S. 79° E,  
54 links, but no scribing is visible; badly burned.  
Evidence of tumbled down rock mound.

**PHOTO IDENTIFICATION DATA**

Photo No. EQO (7/19/66) 2-288

Filed At. \_\_\_\_\_

Object Ident. 10" fir

Ident. By Tom Sutherland

*Signature*

**DESCRIBE CORNER LOCATION RELATIVE TO NEAR-BY FEATURES, ALSO HOW TO REACH CORNER**

Identified area on aerial photo from topog map.

**PLANE COORDINATE POSITION DATA**

State \_\_\_\_\_ Zone \_\_\_\_\_

X \_\_\_\_\_

Y \_\_\_\_\_

Estab. By \_\_\_\_\_

*Agency*

Signature  
Ken Magoon

Title  
Engr Aid

Division  
USFS, Umatilla NF, S.O.

Headquarters  
9/18/69

Date  
9/18/69

7100-52 (3/68)

CORNER RECORD (PERPETUATION)

MONUMENT: DESCRIBE NEW MONUMENT SET, OR WORK DONE TO PRESERVE EXISTING MONUMENT

ACCESSORIES : DESCRIBE NEW BT'S WITNESS OBJECTS ETC. ESTABLISHED, OR WORK DONE TO PRESERVE EXISTING EVIDENCE

Posted BT, Attention, and corner location signs.  
Painted stump BT red.  
Red flagging in area.

Work Done By, Mike Lilly Title Engr. Aid Date 8/28/69 State Registration No. USFS  
or Agency

Certified Cor. Record Prepared ? Yes (No) Filed At: Date

REMARKS

Pin pricked a 10" DBH fir tree bearing S. 67° E, 106 links from the BT stump.  
Posted location sign (54-6) approx. 1/2 chain west of corner on road. Corner easily  
seen from road.

Index File No. R-25 T. 1 S. R. 35 E. M. Will. Tract or Surv. No. Cor. R-25