

USDA-FOREST SERVICE

Index File No. 0-24-80

CORNER RECORD (SEARCH)

(Ref. FSM 7151.4)

Tract or Survey No. _____

Cor. No. _____

T 1S R. 3SE

R.D. WALLA-WALLA County UMATILLA

Merid. W.M.

N.F. UMATILLA State OREGON

CORNER DIAGRAM

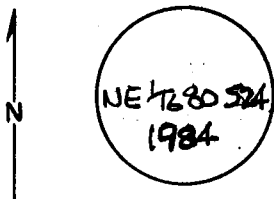

DESCRIBE CORNER MONUMENT FOUND

FND BLM BRASS CAP RISING 6" ABOVE GROUND.

DESCRIBE BEARING TREES OR OTHER OFFICIAL ACCESSORIES FOUND

14" D. FIR BLAZED & SCRIBED NE 1/4 80 324 BT BEARS N 04 1/2° E 46 LKS

10" W. FIR BLAZED & SCRIBED NE 1/4 80 324 BT BEARS S 82° W ~ 13 1/2 LKS

PHOTO IDENTIFICATION DATA

Photo No. _____

Filed At. _____

Object Ident. _____

Ident. By _____

Signature

DESCRIBE CORNER LOCATION RELATIVE TO NEAR-BY FEATURES, ALSO HOW TO REACH CORNER

FROM E 1/4 80 324 FOLLOW POSTED LINE SOUTH 1/4 MILE TO CORNER

CORNER IS ON EAST SLOPE 100' ABOVE BUTCHER CREEK

PLANE COORDINATE POSITION DATA

State _____ Zone _____

X _____

Y _____

Estab. By _____

Agency

Signature Stallons

Title LS 1848

Division _____

Headquarters _____

Date

5-85

FS-7100-52 (3/68)

CORNER RECORD (PERPETUATION)

MONUMENT: DESCRIBE NEW MONUMENT SET, OR WORK DONE TO PRESERVE EXISTING MONUMENT

NONE

ACCESSORIES : DESCRIBE NEW BT'S WITNESS OBJECTS ETC. ESTABLISHED, OR WORK DONE TO PRESERVE EXISTING EVIDENCE

SET STEEL FENCE POST 3 FT. WEST OF CORNER.

ATTACHED SIGNS TO POST & BT'S. PAINTED RED BANDS.

Work Done By B. A. SUTTON Title SURVEYOR Date 5-85 State Registration No. LS 1848
or Agency

Certified Cor. Record Prepared? Yes No Filed At: _____ Date _____

REMARKS

Index File No.

0-24-80

T.

LS

R.

3SE

W.M.

Tract or Surv. No.

GPO: 1982 O-382-659

Cor.

NE 1/6 80524