

OREGON CORNER RESTORATION FORM

COUNTY: Umatilla **DATE:** Remonumented 9/08/95. Revisited October 2001, there are no changes from 1994 corner certificate except for GPS co-ordinate, which is shown on this certificate.

CORNER DESIGNATION: A-25. Northeast corner Section 1, T1S., R34E., W.M.

PREVIOUS RENEWALS/SURVEYS, ETC.: Corner originally established by James P. Currin and James E. Noland, under Special Contract, dated May 4, 1887.

Surveyor General records state:

Set basalt stone, 12 x 9 x 7 ins., 8 ins. in ground for Closing Cor. to Tps. 1 S., Rs. 34 & 35 E., marked 6 notches on S.E. and W. edges and C.C. on S. face, from which:

A pine, 12 ins. diam., brs. S. 40° E., 190 lks. dist. marked T.1S., R.35E., S.6, C.C., BT.

A pine, 20 ins. diam., brs. S. 20° W., 208 lks. dist., marked R.34E., S.1, C.C., BT.

No other trees in limits.

RECORD 95-16-C, 9/08/95: Found mound of stone at corner position and a decayed pine stump which bears S 20° W, 208 lks, (137.3 ft), per record for Section 1.

MONUMENT MARKING DETAIL:

AM
T1N R35E
S31

R34E S1 | S6 R35E
CC
T1S
1995
ORLS 1106

MONUMENT AND ACCESSORIES FOUND: Found a 2 1/2" brass cap on a 1 1/2 in. galvanized iron pipe, projecting 6 in. with a 2 foot diameter mound of stone (marked as shown in the monument detail).

From which:

The decayed 30 in. pine stump (original bearing tree) bears S 20° W, 137.3 feet.

A 7 in. ponderosa pine with double blaze scribed "T1S R35E S6 AM BT" bears S 47° E., 71.1 feet.

A 12" ponderosa pine with double blaze scribed "T1S R34E S1 AM BT" bears S 28° W, 108.5 feet.

A 5/8" iron rebar with yellow plastic cap marked "OR PLS 1106-WA PLS 17372" bears N 42° E, 20.2 feet.

A 5/8" iron rebar with yellow plastic cap marked "OR PLS 1106, WA PLS 17372" bears N 39° W, 22.1 feet.

A 1/2" brass washer marked "PLS 1106" is nailed to lower blaze of each bearing tree.

Bearing object signs are attached to each iron rebar. There is a steel fence post near each rebar accessory with witness sign attached.

LOCATION & COMMENTS: Corner falls 10 feet North of forest road. Amended monument is located N 00°21'40" E 4.64 feet from South line of Section 31.

STATE PLANE CO-ORDINATE:

Oregon North, NAD 83/91, International Foot:

N = 680347.62

E = 8717656.41

COMPASS DECLINATION: 18° East.

FIRM/AGENCY: William R. Wells, PLS

P.O. Box 1696

Pendleton, Oregon 97801

Witness: Jason M. Wells, LSIT

Mark Hammersla

\IS34A25

Surveyor's Seal

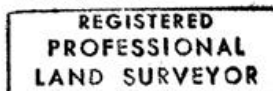

William R. Wells

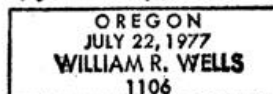

renews 6-30-02

RECEIVED BY
Umatilla County Surveyor
Date 11-01
Rec'd By KE
No. 01-176-R