

**OREGON CORNER RELOCATION FORM**

Section 3 Township 1S Range 34E  
 County Umatilla Date: August 1, 1997

Corner Designation: 1S34C17  
 Condition Report Only  
 Not found  
 Quarter corner to sections 2 and 3, T1S, R34E W.M. x Remonumented  
 Unrecorded  
 Surveyed in  
x Referenced out

Previous Renewals / Surveys, etc.  
 Corner originally set by Currin and Nolan under special contract dated May 4, 1887.  
 His record reads: Set post, 3 ft. long, 3 ins. sq., 2 ft. in ground, marked 1/4 S. on W. face, for 1/4 Sec. Cor, from which a pine, 12 ins. diam., bears N. 45°W., 41 lks. dist. marked 1/4 S. B. T.; a pine, 12 ins. diam., bears S.52°E., 38 lks. dist. marked 1/4 S. B. T.

Monument and Accessories found: ( condition and source )  
 Two Ponderosa Pine stumps, of correct size and vintage, were found witnessing a point 22 feet south of the proportioned point. One stump bears N42°53'W, 27.88 feet and the other bears S49°57'E, 25.42 feet. A K tag has been on a tree 7 feet sw of the point and a blazed line runs east from the point. A north-south fence is 3 feet west of the point.

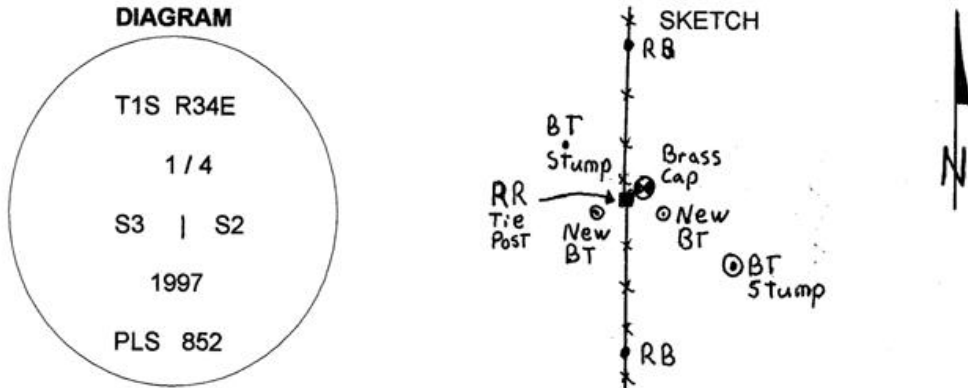

MONUMENT (S) AND ACCESSORIES SET (Procedures and Description)  
 Set a 1 1/4" x 30" Galvanized Iron Pipe with a 2 1/2" brass cap stamped as shown in the diagram above at the position measured from the witness stumps. The cap is 1" below the surface of the ground.

For references, I set two 5/8" by 24" rebars with 1.25" red plastic caps stamped ORLS 852 and WAL5 13922 as described below:  
 a rebar bears N6°19'W, 49.49 feet under the existing fence at the base of a Ponderosa Pine.;  
 a rebar bears S3°46'W, 71.31 feet at the base of a Ponderosa Pine ;  
 I also set two bearing trees as described below:  
 A 13" diameter Ponderosa Pine bears S68°36'W, 7.37 feet scribed 1/4 S BT.  
 A 9" diameter Ponderosa Pine bears S62°26'E, 5.41 feet scribed 1/4 S BT.  
 The bearing trees have a 1 1/4 inch brass washer stamped ORLS852 and WAL513922 nailed between the letters B and T.  
 Monument and reference locations were surveyed with theodolite from two GPS control points.  
 The bearings and distances are true

Location and comments                      Compass Declination                      Surveyors Seal

RECEIVED BY:  
Umatilla County Surveyor  
 Date: 9-97  
 Rec'd By: AK  
 No. 97-173-B

Firm / Agency  
 Haddock Surveying  
 Address  
 P.O. Box 1574  
 Pendleton, Or. 97801  
 Party Chief  
 David L. Haddock  
 Witness  
 Stephen K. Haddock

