

OREGON CORNER RECONSTRUCTION FORM

Section 2 Township 1S Range 34E
 County Umatilla Date: Dec 22, 1997

Corner Designation: 1S34A19

North 1/4 corner to section 2
 T1S, R34E, W.M.

Condition Report Only
 Not found
 Remonumented
 Unrecorded
 Surveyed in
 Referenced out

Previous Renewals / Surveys, etc.
 Closing 1/4 corner not established during original survey by Currin and Noland.

Monument and Accessories found: (condition and source)
 None.

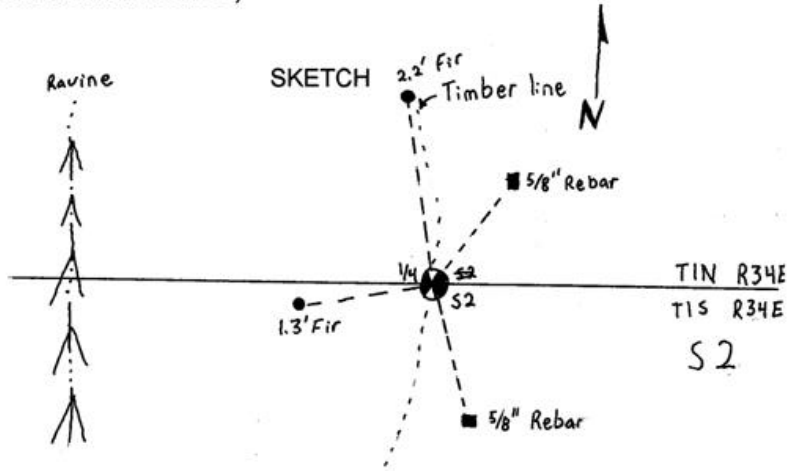
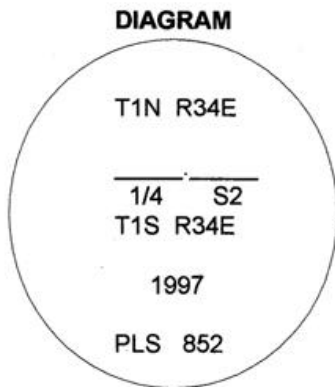

MONUMENT (S) AND ACCESSORIES SET (Procedures and Description)

Set a 2 1/2" Brass cap on a 1 1/4"x30" galvanized iron pipe 27" in the ground on the east side of a steep draw at the edge of the timber stamped as shown in the diagram above.

For references, I set two 5/8" by 24" rebars with 1.25" red plastic caps stamped ORLS 852 and WALS 13922 as described below:

- a rebar bears N46°E, 25.1 feet;
- a rebar bears S21°E, 27.9 feet;

ALSO: Bearing trees with attached 1 1/8" brass washer stamped ORLS 852 and WALS 13922
 A 2.2' DBH Douglas fir bears N4°W, 37.2 feet;
 A 1.3' DBH Douglas fir bears S86°W, 26.9 feet;

The monument was set by a closed loop traverse using a Geodimeter System 600 Electronic Total Station. References were set and located using a compass and steel chain.

Location and comments

Compass Declination

Surveyors Seal

20°

RECEIVED BY:
Umatilla County Surveyor
 Date: 1-98
 Rec'd By: KK
 No. 98-06-B

Firm / Agency
 Haddock Surveying
 Address
 P.O. Box 1574
 Pendleton, Or. 97801
 Party Chief
 Stephen K, Haddock

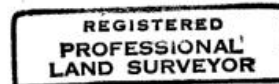

David L. Haddock

