

# OREGON CORNER RESTORATION FORM

**COUNTY:** Umatilla **DATE:** Maintained on 10/5/94. Revisited October 2001, there are no changes from 1994 corner certificate except new GPS co-ordinate, which is shown on this certificate.

**CORNER DESIGNATION:** A-1. Northwest corner Section 6, T1S., R34E., W.M.

**PREVIOUS RENEWALS/SURVEYS, ETC.:** Most recent approved GLO Survey was made by L.E. Wilkes, under Contract No. 29, dated Feb. 20, 1917. Notes state: "Set an iron post, 3 ft. long, 2 ins. diam., 24 ins. deep among rocks on steep E. slope, for closing cor. of secs. 1 and 6, with brass cap (marked as shown in monument detail) from which:

A cross (x) on a basalt stone, a part of irregular bluff facing N., bears S.19°E., 25 lks. dist., with C C 6 B O marked beside the cross. A cross (x) on a basalt stone in place, 1x1x1 ft. above ground, bears S. 54°W., 11 lks. dist., with C C 1 B O marked beside the cross."

### MONUMENT AND ACCESSORIES FOUND:

A 2 1/2" brass cap on 2" galvanized iron pipe, on east edge of basalt outcropping, protruding 8" out of ground, (marked as shown in monument detail). Impractical to rebuild mound, nearly vertical on East side. From the found monument: Faint chisel marks on a 1' x 1' x 1' rock outcrop bear S 54° W - 7.3 feet. Marks "1 B" are visible (Wilkes bearing object).

### MONUMENT MARKING DETAIL:

U.S. G L O SURVEY

T1N

R34E

S31

-----  
S1 | S6

R33E R34E

T1S

1917

Accessories to existing corner monument:

A steel fence post 1.2 feet North of monument with witness post attached.

"XBO" chiseled on 1' x 1' x 1.5' outcropping bears S 24° E-7.2 feet, on a smooth surface on top of rock outcropping.

"XBO" chiseled on 2' x 3' x 5' outcropping bears S 16° E-21.7 feet, on smooth surface on top of rock outcropping.

"XBO" chiseled on 3.5 x 3.0 x 2.5 outcropping bears S 21° W-15.6 feet on smooth vertical face 0.5 feet above base of outcrop.

"XBO" chiseled on 2.0 x 1.0 x 1.0 outcropping bears S 46° W-13.7 feet on smooth surface on top of rock outcropping.

Measured to "X" on "XBO" marks.

### LOCATION & COMMENTS:

Corner is located South of East-West fence line.

### STATE PLANE CO-ORDINATE:

Oregon North Zone, NAD 83/91, International Foot:

N = 679566.54

E = 8685821.62

**COMPASS DECLINATION:** 18° East.

Surveyor's Seal

**FIRM/AGENCY:** William R. Wells, PLS

P.O. Box 1696

Pendleton, Oregon 97801

Party Chief: Jason M. Wells, LSIT

Witness: Mark Hammersla

1S34A1

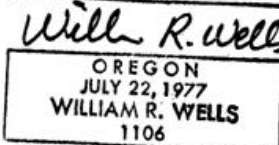
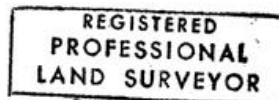

renews 6-30-02

RECEIVED BY

Umatilla County Surveyor

Date 11-01

Rec'd By KK

No. 01-125-B