

**CERTIFICATE OF MONUMENTATION**

March 30, 2010

I, Stephen K. Haddock, do hereby certify that I am a registered surveyor in the State of Oregon and that I referenced and reset a 5/8" x 24" iron rebar with a red plastic cap stamped ORLS 852 that was initially set to monument the northwest corner of Parcel 2, Partition Plat 1996-28, recorded in the Records of Umatilla County, Oregon, on August 7, 1996 as Instrument Number 1996-221680. This same monument was held as the northeast corner of Hatley Addition recorded in the Umatilla County Records on September 30, 1996 in Plat Book 13, Page 89 as instrument Number 1996-223552 and was also held as the northwest corner of Parcel 1 of Partition Plat 2009-17 recorded in the Umatilla County Records on June 1<sup>st</sup>, 2009 as instrument Number 2009-551070:

During recent construction the original monument was buried under approximately 10 feet of fill material. I did not remove the original monument but set a new one flush in the top of the new fill at the exact corner location above the original monument. The new monument is a 5/8" x 24" iron rebar with a 1 1/8" orange plastic cap stamped WTS and 56295LS.

*Stephen K. Haddock*

Stephen K. Haddock

Registered Land Surveyor No. 56295LS

State of Oregon

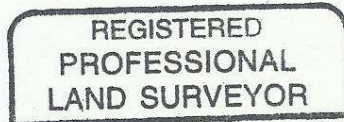

*Stephen K. Haddock*

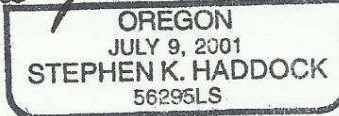

RENEWAL DATE 6-30-11

**WITNESS TREE SURVEYING**

STEPHEN K. HADDOCK, PLS

P.O. BOX G

PILOT ROCK, OREGON 97868

(541) 443-2922 ph.

RECEIVED BY  
Umatilla County Surveyor  
Date 5-10  
Rec'd By KK  
Date 10-03-10