

OREGON CORNER RELOCATION FORM

Section 15 Township 1S Range 32E
 County Umatilla Date: May 12, 2007

Corner Designation: 1S32N17

Condition Report Only
 Not found
 Remonumented
 Unrecorded
 Surveyed in
 Referenced out

Corner to sections 14, 15, 22, and 23, T1S, R32E, W.M., Umatilla County, Oregon.

Previous Renewals / Surveys, etc.

Corner originally set by Daniel Chaplin under contract No. 107 dated September 21, 1864. His record reads: Set post for Cor. to Secs. 14, 15, 22 & 23, in mound of earth, with charred stake, pits, etc., as per instructions.

The road notes for County Roads 292 and 376 indicate that this corner was on the road centerline.

Monument and Accessories found: (condition and source)

None. The point falls at the intersection of County Roads to the North, East and South and a fence line running west.

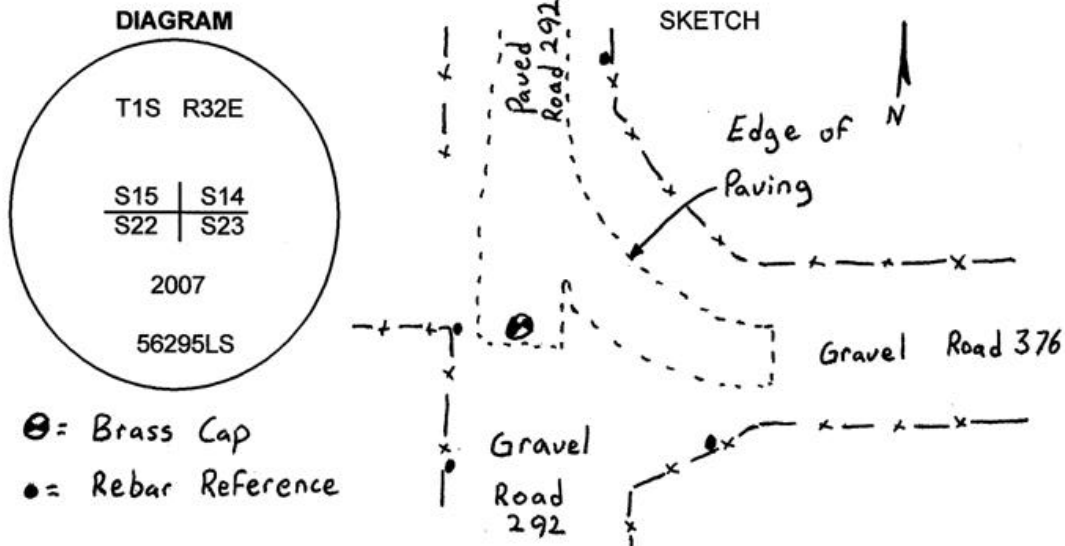

MONUMENT (S) AND ACCESSORIES SET (Procedures and Description)

I set a 1 1/2" x 30" galvanized iron pipe with a 2 1/4" brass cap stamped as shown in the diagram above at the intersection of the County Roads and fence line to the west. The cap is approximately 8" below the surface of the road.

For references, I set four, 5/8" by 24" rebars with 1 1/8" orange plastic caps attached, stamped WTS and 56295LS as described below:

- an iron rebar bears N88°46'32"W, 27.92 feet ;
- an iron rebar bears N14°56'37"E, 118.89 feet;
- an iron rebar bears S38°40'08"W, 44.66 feet;
- an iron rebar bears S66°04'40"E, 78.93 feet;

The monument and references were tied using a Trimble R7/R8 RTK GPS.

Location and comments

Compass Declination

Surveyors Seal

RECEIVED BY:
Umatilla County Surveyor
 Date: 7-07
 Rec'd By: KK
 No. 07-192-B

Firm / Agency
 Witness Tree Surveying
 Address
 P.O. Box G
 Pilot Rock, Or. 97868
 Party Chief
 Stephen K, Haddock

REGISTERED
 PROFESSIONAL
 LAND SURVEYOR

Stephen K. Haddock

OREGON
 JULY 9, 2001
 STEPHEN K. HADDOCK
 56295LS

RENEWAL DATE 6-30-09