

Index

File No. V-0125

CORNER RECORD (SEARCH)

(Ref. FSM 7151.4)

Tract or Survey No. _____ Cor. No. _____

T 1N R. ~~57E~~ 36E

R.D. WALLA WALLA County UMATILLA

Merid. WILLAMETTE

N.F. UMATILLA State OREGON

CORNER DIAGRAM

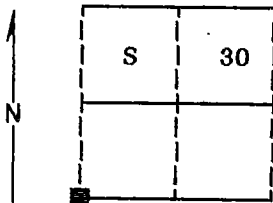

DESCRIBE CORNER MONUMENT FOUND

Found no evidence of the original corner monument.

DESCRIBE BEARING TREES OR OTHER OFFICIAL ACCESSORIES FOUND

Found a 30 inch diameter Ponderosa Pine N5°W, 360 lks, dead, down and rotted with faint scribes visible.

PHOTO IDENTIFICATION DATA

12 616140A 787-58

Photo No. _____

Filed At. Ranger Office

Object Ident. Bearing Tree

Ident. By D.I. Griffith

Signature

PLANE COORDINATE POSITION DATA

State _____ Zone _____

X _____

Y _____

Estab. By _____

Agency

Signature

DESCRIBE CORNER LOCATION RELATIVE TO NEAR-BY FEATURES, ALSO HOW TO REACH CORNER

Corner falls on very steep West face approximately 150 feet below the top of the ridge and approximately 4000 feet North of the end of the 020 road.

Title Surveyor

Division _____

Headquarters _____

Date 9-19-89 FS-7100-52 (3/68)

Handwritten signature of D.I. Griffith

CORNER RECORD (PERPETUATION)

MONUMENT: DESCRIBE NEW MONUMENT SET, OR WORK DONE TO PRESERVE EXISTING MONUMENT

Set a 2½"x30" aluminum pipe with aluminum cap marked as shown:
Pipe is set 20 inches in the ground.

T1N	
R36E	R37E
S 25	S 30
S 36	S 31
1989	
OPLS 644	

Raised a mound of stone around monument, 4 ft. base to top of cap.

ACCESSORIES : DESCRIBE NEW BT'S WITNESS OBJECTS ETC. ESTABLISHED, OR WORK DONE TO PRESERVE EXISTING EVIDENCE

New Bearing Tree and Bearing Objects:

Drove a PK nail in the lower center of a 8'x4' rock face,
with BO chiseled below, bears N62°E, 13.87 feet.
A 5/8"x20" iron pin with plastic cap marked BGA SURVEY MARKER bears S44°E, 10.40 feet
A 1/2"x20" iron pin with plastic cap marked BGA SURVEY MARKER bears S20°W, 9.62 feet
A 14 inch diameter Ponderosa Pine bears N6°W, 206.84 feet marked T1N R36E S25 BT
Painted a 6 inch red band around all BTs and the rock bearing object. Attached bearing tree signs to all BTs and BOs and land survey monument signs to BTs. Set a steel fence post approximately 5 feet North with 54-9 and 54-2 signs attached.

10

Work Done By D.I. Griffith Title Surveyor Date 9-12-89 State Registration No. OPLS 644
or Agency

Certified Cor. Record Prepared? Yes No Filed At: Umatilla Co. Surveyor's Office Date 9-89

11

REMARKS

Witness: Jeff Petersen

12

Index File No. V-~~25~~ T. 1N

R. ~~37E~~ W.M.

Tract or Surv. No.

Cor.

13

25

36E

USDA-FOREST SERVICE

Index File No. V-25

CORNER RECORD (SEARCH)

(Ref. FSM 7151.4)

Tract or Survey No. _____ Cor. No. _____

T IN R. 36E

R.D. WALLA WALLA County UMATILLA

Merid. WILL

N.F. UMATILLA State OREGON

CORNER DIAGRAM

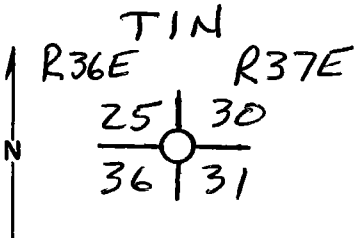

DESCRIBE CORNER MONUMENT FOUND

NONE

DESCRIBE BEARING TREES OR OTHER OFFICIAL ACCESSORIES FOUND

NONE - I DID NOT FIND THE EVIDENCE RECOVERED BY BILL MOORE IN 1977, I MAY HAVE BEEN TOO FAR WEST WITH MY SEARCH AREA.

PHOTO IDENTIFICATION DATA

Photo No. _____
Filed At. _____
Object Ident. _____
Ident. By _____

Signature

PLANE COORDINATE POSITION DATA

State _____ Zone _____
X _____
Y _____
Estab. By _____

Agency

Signature

Title

Division

Headquarters

Date

FS-7100-52 (3/68)

Dennis L. Gaylord

LS 1636

S.O.

6-88

CORNER RECORD (PERPETUATION)

MONUMENT: DESCRIBE NEW MONUMENT SET, OR WORK DONE TO PRESERVE EXISTING MONUMENT

9

ACCESSORIES : DESCRIBE NEW BT'S WITNESS OBJECTS ETC. ESTABLISHED, OR WORK DONE TO PRESERVE EXISTING EVIDENCE

10

Work Done By _____ Title _____ Date _____ State Registration No. or Agency _____

Certified Cor. Record Prepared ? Yes No Filed At: _____ Date _____

11

REMARKS

12

Index File No. T. R. M. Tract or Surv. No. Cor. 13

CORNER RECORD (SEARCH)

(Ref. FSM 7151.4)

Tract or

Survey No. 7

No. V-1

Index
File No. V-1

T IN R. 37E

R.D. Pendleton County Umatilla

Merid. Willamette N.F. Umatilla State Oregon

CORNER DIAGRAM

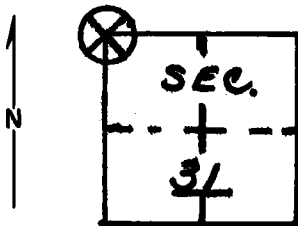

DESCRIBE CORNER MONUMENT FOUND

None.

DESCRIBE BEARING TREES OR OTHER OFFICIAL ACCESSORIES FOUND

Twin down p. pine trees on top of ridge. One tree has faint line blaze on it. The other one has what appears to be a scribed B; trees have been burned.

PHOTO IDENTIFICATION DATA

Photo No. _____
 Filed At. _____
 Object Ident. _____
 Ident. By _____
 Signature _____

DESCRIBE CORNER LOCATION RELATIVE TO NEAR-BY FEATURES, ALSO HOW TO REACH CORNER

Open hillside to south. Location is on steep west slope.

PLANE COORDINATE POSITION DATA

State _____ Zone _____
 X _____
 Y _____
 Estab. By _____
 Agency _____

Signature
Bill Moore

Title
Eng, Tech.

Division

Headquarters

Date

10/5/77

7100-52-(3/68)

CORNER RECORD (PERPETUATION)

 MONUMENT: DESCRIBE NEW MONUMENT SET, OR WORK DONE TO PRESERVE EXISTING MONUMENT

 ACCESSORIES: DESCRIBE NEW BT'S WITNESS OBJECTS ETC. ESTABLISHED, OR WORK DONE TO PRESERVE EXISTING EVIDENCE

 Work Done By _____ Title _____ Date _____ State Registration No. _____
 or Agency _____

 Certified Cor. Record Prepared ? Yes No Filed At: _____ Date _____

REMARKS

 Index File No. T. R. M. Tract or Surv. No. Cor.
