

USDA-FOREST SERVICE

Index

File No. Z-21

CORNER RECORD (SEARCH)

(Ref. FSM 7151.4)

Tract or

Survey No. \_\_\_\_\_

Cor.

No. \_\_\_\_\_

T 2N R. 36E

R.D.

Walla Walla

County

Umatilla

Merid. Willamette

N.F.

Umatilla

State

Oregon

CORNER DIAGRAM Sec.36

DESCRIBE CORNER MONUMENT FOUND

Searched for but not found.

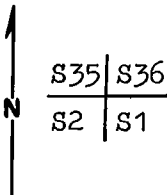

DESCRIBE BEARING TREES OR OTHER OFFICIAL ACCESSORIES FOUND 2

PHOTO IDENTIFICATION DATA

Photo No. 1280-48

Filed At Umatilla N.F.

Object Ident. two I.P.'s

Ident. By L. B. Bishop  
Signature 7

DESCRIBE CORNER LOCATION RELATIVE TO NEAR-BY FEATURES, ALSO HOW TO REACH CORNER 3

PLANE COORDINATE POSITION DATA

State \_\_\_\_\_ Zone \_\_\_\_\_

X \_\_\_\_\_

Y \_\_\_\_\_

Estab. By \_\_\_\_\_  
Agency 8

Signature  
Larry J. Bishop

Title  
Land Surveyor

Division \_\_\_\_\_

Headquarters \_\_\_\_\_

Date 6/83

7100-52-(3.68) 4

5

**CORNER RECORD (PERPETUATION)**

**MONUMENT : DESCRIBE NEW MONUMENT SET, OR WORK DONE TO PRESERVE EXISTING MONUMENT**

Set 2½" x 30" Aluminum pipe with a 2½" Aluminum cap 15" in ground-built mound of stone 3 ft. base 12" high.

**ACCESSORIES : DESCRIBE NEW BT'S WITNESS OBJECTS ETC. ESTABLISHED, OR WORK DONE TO PRESERVE EXISTING EVIDENCE**

R/R spike set flush on point of rocks N14W-97.9 ft.  
R/R spike set flush on point of rocks S78-30W-318.6 ft.  
5/8"x30" Iron rod with red plastic cap stamped PLS 896 N42-30E-79.6 ft..  
24" D-Fir S38E-235.0 ft. scribed T1NR36ES1BT and with a 1" Brass disk stamped PLS 896.

Work Done By Larry D. Bishop Title Surveyor Date 6/83 State Registration No. 896  
or Agency

Certified Cor. Record Prepared ? Yes No  Filed At: \_\_\_\_\_ Date \_\_\_\_\_

**REMARKS**

Set guard posts East & North with signs 54-2 and 54-4.  
Nailed 54-4 and BT signs to BT and painted band and blazes red.

Index File No. 7-21 T.

R.

M.

Tract or Surv. No.

Cor.

Index

File No. Z-21

CORNER RECORD (SEARCH)

(Ref. FSM 7151.4)

Tract or

Survey No. \_\_\_\_\_

Cor.

No. \_\_\_\_\_

T 2N R. 36E

R.D. WALLA WALLA County UMATILLA

Merid. WILL

N.F. UMATILLA State OREGON

CORNER DIAGRAM

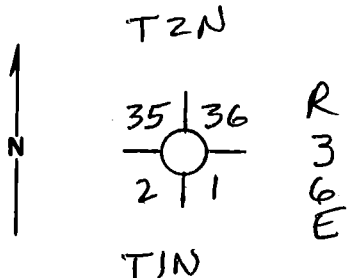

DESCRIBE CORNER MONUMENT FOUND

NONE FOUND

DESCRIBE BEARING TREES OR OTHER OFFICIAL ACCESSORIES FOUND

NONE SET

PHOTO IDENTIFICATION DATA

Photo No. \_\_\_\_\_

Filed At. \_\_\_\_\_

Object Ident. \_\_\_\_\_

Ident. By \_\_\_\_\_

Signature

PLANE COORDINATE POSITION DATA

State \_\_\_\_\_ Zone \_\_\_\_\_

X \_\_\_\_\_

Y \_\_\_\_\_

Estab. By \_\_\_\_\_

Agency

Signature

Title

Division

Headquarters

Date

7100-52 (3, 68)

*Dennis L. Gaylord*

PLS 1636

7-20-82

**CORNER RECORD (PERPETUATION)**

**MONUMENT : DESCRIBE NEW MONUMENT SET, OR WORK DONE TO PRESERVE EXISTING MONUMENT**

**ACCESSORIES : DESCRIBE NEW BT's WITNESS-OBJECTS ETC. ESTABLISHED, OR WORK DONE TO PRESERVE EXISTING EVIDENCE**

**Work Done By** \_\_\_\_\_ **Title** \_\_\_\_\_ **Date** \_\_\_\_\_ **State Registration No.** \_\_\_\_\_  
**or Agency** \_\_\_\_\_

**Certified Cor. Record Prepared ?** Yes No **Filed At:** \_\_\_\_\_ **Date** \_\_\_\_\_

**REMARKS**

**Index File No.**      **T.**      **R.**      **M.**      **Tract or Surv. No.**      **Cor.**