

Q-7

OREGON CORNER RESTORATION FORM

Section 20 Township IN Range 35E

Q-7

County Umatilla Date 12-2-87

Corner Designation

C-5 1/16

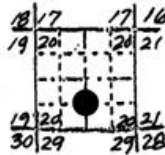

- Condition Report Only
- Not Found
- Renewed
- Unrecorded
- Surveyed In
- Referenced Out

Previous Renewals/Surveys, etc.

Monument(s) & Accessories Found: (Condition and Source)

Monument Detail

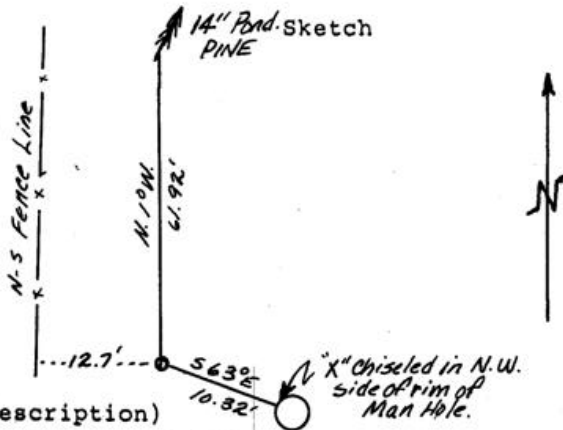

Monument Set (Procedures and Description)

Set 5/8"x30" Iron Rod with yellow plastic cap marked "Oregon State Parks" 20" in the ground. erected stone mound

New Accessories

Blazed 14" ponderosa pine N1°W-61.92' to finishing nail at side & center of tree, scribed "CS1/16S20BT" Chiseled "X" into the NW side of the rim of a sanitary sewer man hole S63°E-10.32' Set orange carsonite post with decal marked "Property boundary State Park Land behind this sign" 2.0 East

Location & Comments

Compass Declination 20°

Firm/Agency Oregon State Parks & Recreation Div.

Address 525 Trade Street SE Salem OR 97310

Party Chief R. Hill

Notes R. Hill

Witness H. Hanson L. Boge

Seal

RECEIVED BY

Umatilla County Surveyor

Date 2-88

Rec'd by JA

No. 88-11-B

REGISTERED PROFESSIONAL LAND SURVEYOR

*John E. Hollingsworth*

OREGON JULY 9, 1985 JOHN E. HOLLINGSWORTH 691