

CERTIFIED RECORD OF LAND CORNER MONUMENTATION

HISTORY OF ORIGINAL CORNER ESTABLISHED:

Corner not previously established.

T 1 N R 35 E Q-18.5E

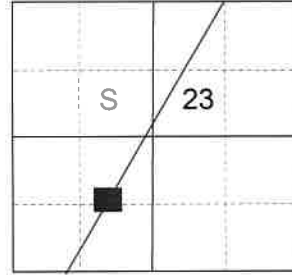

DESCRIPTION OF CORNER EVIDENCE FOUND:

None found.

DESCRIPTION OF MONUMENT AND ACCESSORIES I ESTABLISHED TO MONUMENT THE ORIGINAL LOCATION OF THIS CORNER:

At position by Survey I set a 5/8" x 30" iron pin, 28" in the ground, with 2 1/2" aluminum cap marked as shown below, in a collar of stone 2 ft. in diam., from which:

NEW BEARING OBJECTS:

A 12" White Fir bears North 47° East, a dist. of 24.60 ft., marked LOT 7 UIR CC BT.

A 4" Western Larch bears South 78° East, a dist. of 47.20 ft., marked LOT 8 UIR CC BT.

Set steel fence post approx. 1 ft. East

I hereby certify that the corner was monumented on September 22, 2021.

Witness: Kyle A. Tucker, Emmitt Ambert



Renewal Date: June 30, 2023

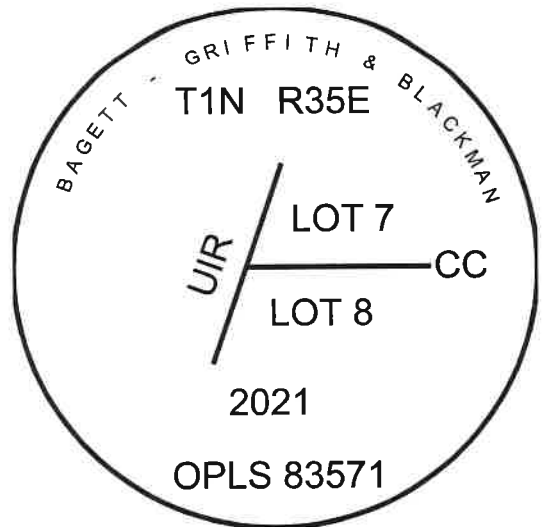

I used a steel tape and magnetic compass in the establishment of the new accessories. I used 14° East declination. Distances are to a 60d spike driven into the right side of the root crown of the bearing trees. Bearings are to a brass washer marked OPLS 83571 is attached to the BT blaze of the new bearing trees.

Q-18.5E

21-125-8