

OREGON CORNER RESTORATION FORM

Section 2 Township 1N Range 32E
 County Umatilla Date: July 1, 2009

Corner Designation: 1N32E19

Condition Report Only
 Not found
 Remonumented
 Unrecorded
 Surveyed in
 Referenced out

Quarter corner common to sections 2 and 11, T1N, R32E, W.M., Umatilla County, Oregon.

Previous Renewals / Surveys, etc.

Corner originally set by Daniel Chaplin under contract no. 107 dated September 21, 1864. His record reads: Set post for 1/4 sec. corner in mound of earth with charred stake, pits &c as per instructions. Zenas F. Moody under contract No. 164 dated October 4, 1871, stated: Set stone 18 x 14 x 7. Currin and Noland under special contract dated May 4, 1887, stated: Set stone, 10 x 9 x 8. In survey H-254-B, McKay Creek National Wildlife Refuge, a brass disc on a concrete post was set.

Monument and Accessories found: (condition and source)

I found a 3" brass cap on a concrete post set by the Refuge Survey stamped as shown in the diagram below.

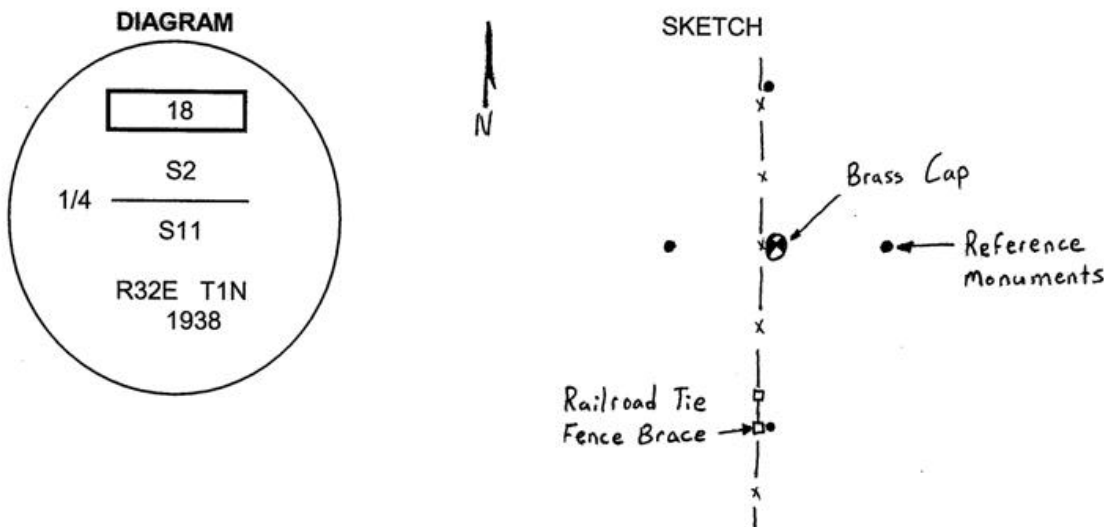

MONUMENT (S) AND ACCESSORIES SET (Procedures and Description)

I set four references at the found monument.

For references, I set four 5/8" by 24" iron rebars with 1 1/4" orange plastic caps stamped WTS and 56295LS as described below:

- an iron rebar bears N0°32'16"E, 44.56 feet;
- an iron rebar bears N82°25'34"W, 30.90 feet;
- an iron rebar bears S89°04'25"E, 33.80 feet;
- an iron rebar bears S0°14'19"E, 39.10 feet;

The monument and references were tied using a Trimble R7/R8 RTK GPS system.

Location and comments
 NAD 83/1991 State Plane Coordinate
 Oregon North Zone
 N = 704,937.06 ift
 E = 8,643,302.81 ift

Compass Declination

Surveyors Seal

RECEIVED BY:
Umatilla County Surveyor
 Date: 6-10
 Rec'd By: KK
 No. 10-93-C

Firm / Agency
 Witness Tree Surveying
 Address
 P.O. Box G
 Pilot Rock, Or. 97868
 Party Chief
 Stephen K, Haddock

REGISTERED
 PROFESSIONAL
 LAND SURVEYOR

Stephen K. Haddock

OREGON
 JULY 9, 2001
 STEPHEN K. HADDOCK
 56295LS

RENEWAL DATE 6-30-11