

OREGON CORNER RESTORATION FORM

Section 31 Township 1N Range 31E
 County Umatilla Date: October 5, 2001

Corner Designation: 1N31Z3

South 1/4 section corner to section 31, T1N, R31E,
 W.M., Umatilla County, Oregon.

Condition Report Only
 Not found
 Remonumented
 Unrecorded
 Surveyed in
 Referenced out

Previous Renewals / Surveys, etc.

The corner was originally set by Josiah Burnett under contract No. 92 dated September 12, 1860. His record reads: Set a post for 1/4 sec. corner. Drove charred stake & raised mound with trench as per instructions.

Monument and Accessories found: (condition and source)
 None. In this area the soil is only around 4" deep over the bedrock.

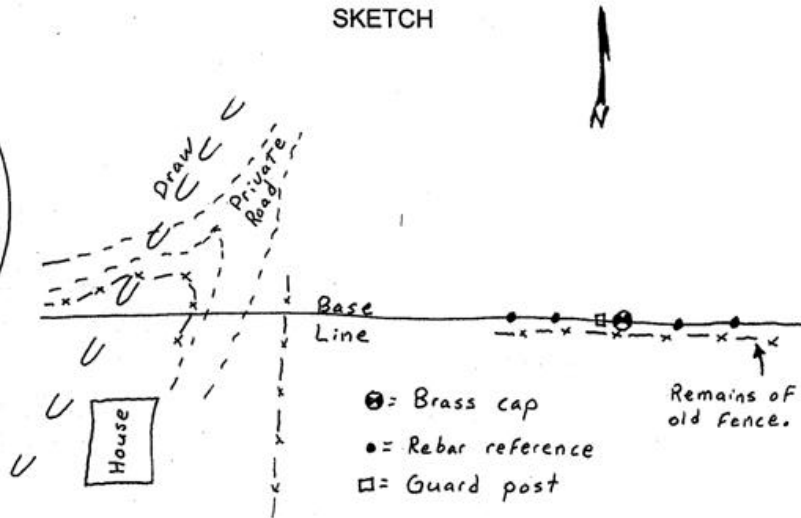
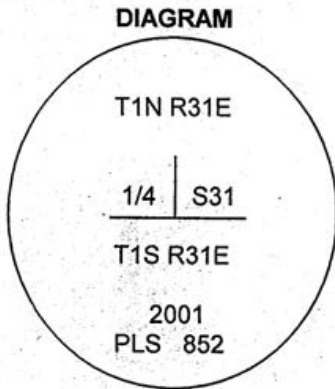

MONUMENT (S) AND ACCESSORIES SET (Procedures and Description)

At the proportionate point I excavated the bedrock to a point 12" below the ground surface. I cemented a 5/8" x 24" iron rebar into a drill hole in the bedrock and I cemented a 15" x 1 1/2" G.I.P. with a 2 1/2" Brass cap stamped as shown in the diagram above to the rebar. I built a mound of stone around the cap and set a 5' steel guard post with a County monument sign attached along side.

For references, I set four 5/8" by 12" rebars with 1 1/4" red plastic caps stamped ORLS 852, and WALS 13922 as described below:

- an iron rebar bears S76°34'41"E, 23.80 feet;
- an iron rebar bears S84°23'26"E, 43.07 feet;
- an iron rebar bears S81°58'13"W, 22.83 feet;
- an iron rebar bears S85°50'27"W, 44.37 feet;

The monument and references were tied using a LIECA SYSTEM 300 RTK GPS.

Location and comments
 OR SPC Oregon North 1983-91
 N = 677808.31
 E = 8590476.41

Compass Declination

Surveyors Seal

RECEIVED BY:
 Umatilla County Surveyor
 Date: 12/20/2001
 Rec'd By: DHK
 No. 01-206-C

Firm / Agency
 Haddock Surveying
 Address
 P.O. Box 1574
 Pendleton, Or. 97801
 Party Chief
 Stephen K, Haddock



RENEWS 6-30-03