

OREGON CORNER RESTORATION FORM

COUNTY: Umatilla. DATE: 03/04/20.

CORNER DESIGNATION: N-21, The Southeast corner of Section 14, Township 1 North, Range 31 East, W.M.

PREVIOUS RENEWALS/SURVEYS ETC: Corner was originally established by Josiah A. Burnett under Contract No. 92 dated September 12, 1860. Notes state: Set post for corner to Sec's. 13,14, 23 and 24, drove charred stake and raised mound with trench as per instructions.

MONUMENT AND ACCESSORIES FOUND:

Found and held a rock mound about 3' West of a North-South fence line. There are other rock mounds from an old fence North of the corner point. Verified position by measuring to fence corner 1/2 mile to South. (See Survey Map).

MONUMENT MARKING DETAIL:

T1N R31E
S14 | S13

S23 | S24
2020
54657PLS

MONUMENT SET: Corner point falls on solid rock in a drainage. Set a 5/8 by 15" rebar in hole drilled in solid rock and surrounded with stones. Capped rebar with a 2" aluminum cap, marked as shown in Monument Marking Detail.

New accessories:

A 5/8 by 15" rebar with blue plastic cap marked "Wells Surveying 54657PLS" bears N 04°51'E, 32.6'.
A 5/8 by 18" rebar with blue plastic cap marked "Wells Surveying 54657PLS" bears N 10°48'E, 16.4'.
A 5/8 by 18" rebar with blue plastic cap marked "Wells Surveying 54657PLS" bears S 11°52'E, 17.1'.
A 5/8 by 18" rebar with blue plastic cap marked "Wells Surveying 54657PLS" bears S 05°36'E, 39.2'.
Wired bearing object signs to rebar accessories. Wired a Witness sign to existing steel fence post in North-South fence line 4' NE of corner monument.
Bearings to accessories are State Plane Grid bearings.

LOCATION AND COMMENTS: Corner is located just West of a North-South fence line.

OREGON STATE PLANE COORDINATE, North Zone NAD 83(91), International Feet Units:

N: 693968.86
E: 8613953.69

FIRM: Wells Surveying
P.O. Box 1696
Pendleton, OR 97801

Surveyor's Seal

\1N31N-21

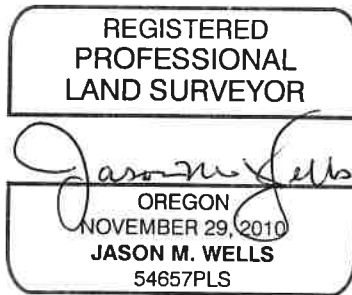

RENEWS: 6:30:20

20-043-C